

ELEVATIONS

Outside View (Scale 1:20)

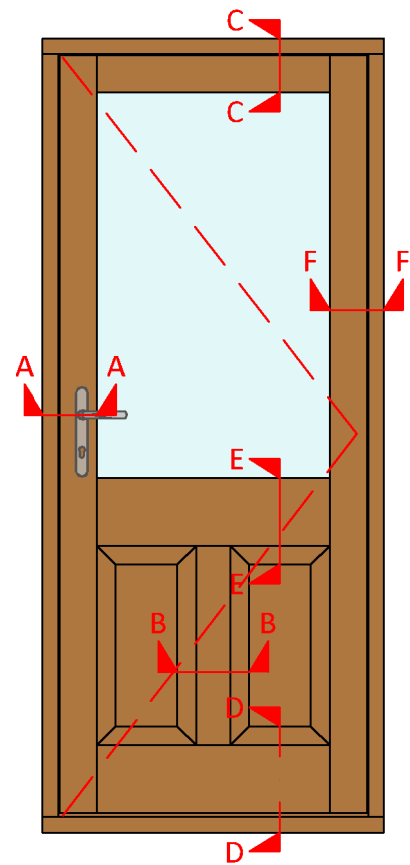

Inside View (Scale 1:20)

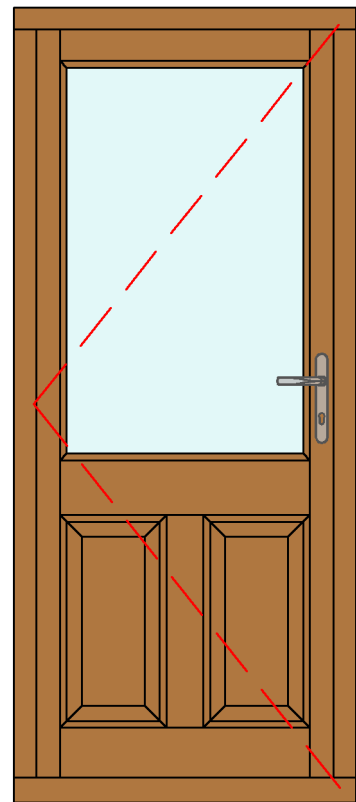

SECTIONS

Section A-A - Jambs (Scale 1:2)

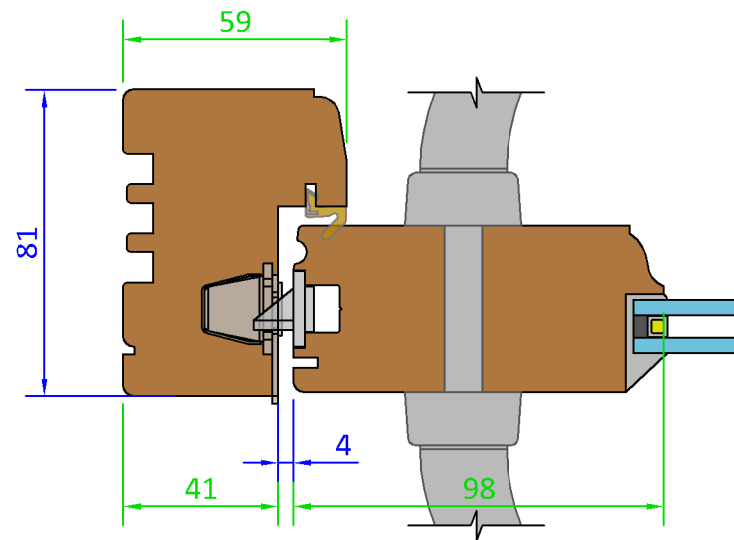

Section B-B - Vertical Rail (Scale 1:2)

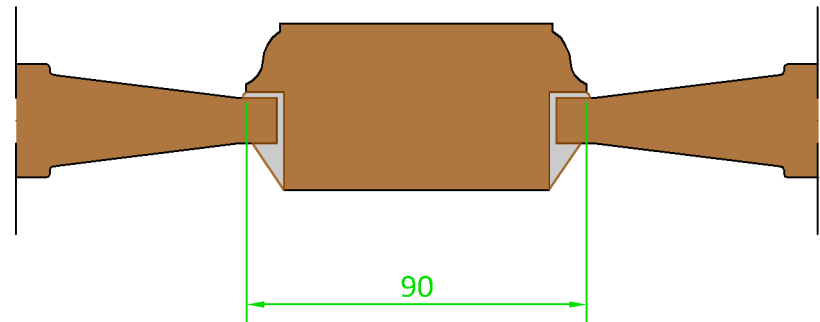

Section C-C - Head Detail (Scale 1:2)

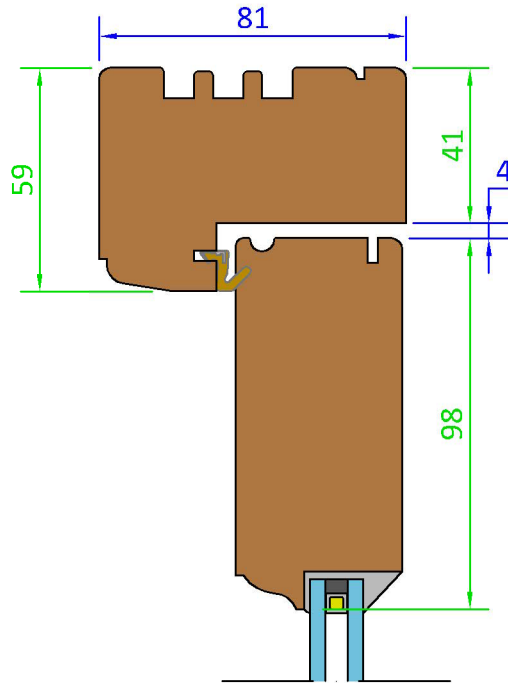

Section D-D - Cill Detail (Scale 1:2)

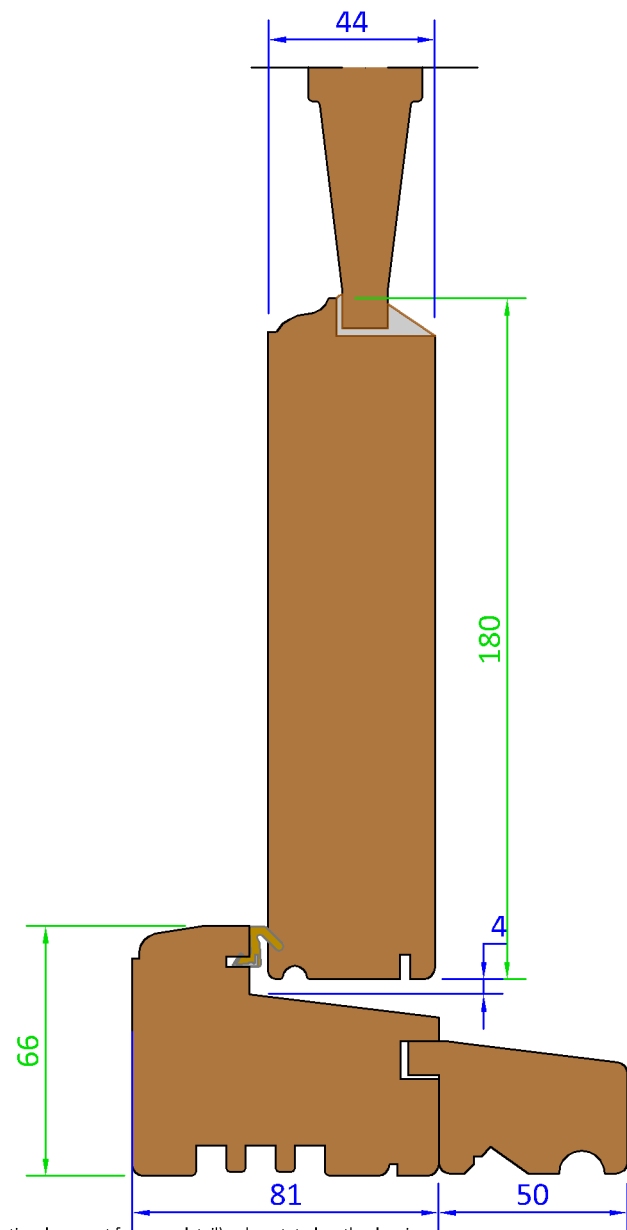

Section E-E - Mid Rail Detail (Scale 1:2)

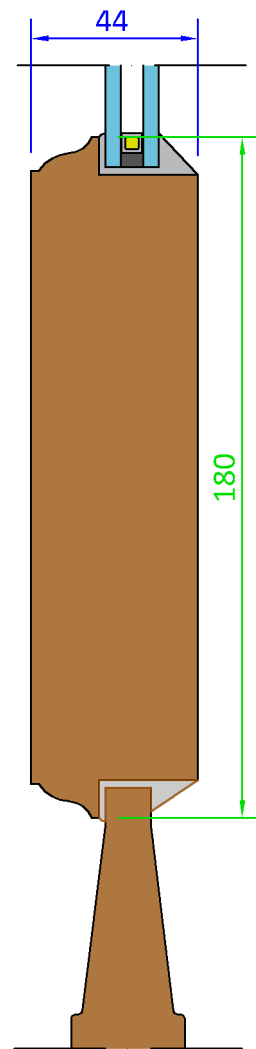

Section F-F - Hinge Detail (Scale 1:2)

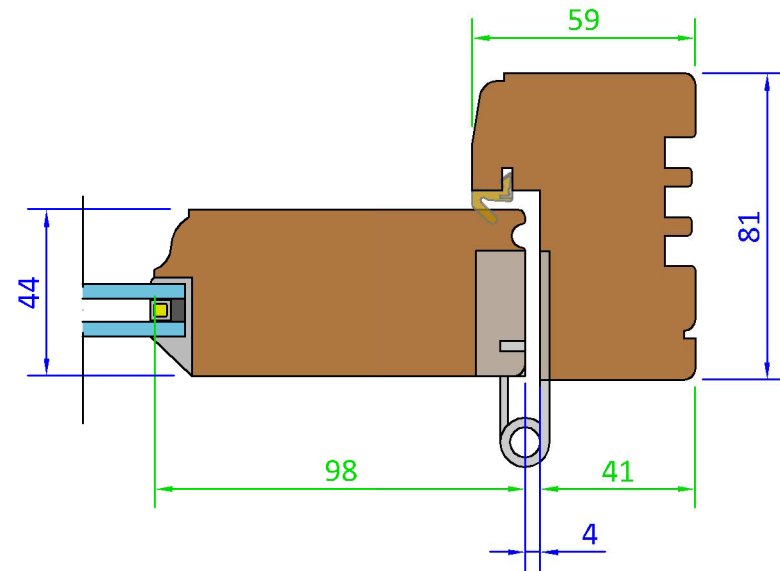

Variable Dimensions
(Dim shown is usually min)

Fixed Dimensions

Tolerances: All tolerances are to George Barnsdale Standard Tolerance definitions (see supporting document for more detail) unless stated on the drawing.
© George Barnsdale & Sons Ltd. All rights reserved. No part of this drawing may be reproduced without the permission of George Barnsdale & Son Ltd.

System: H-DS5-81-44		
Title: Historic Slim - Out Open Doorset (44mm)		
Scale:	As Shown	Rev No: B
Drawn By:	LH	Sheet No: 1
		Date: 14-Mar-18
		Status: Released

GEORGE BARNSDALE
Est. 1884
High Street, Donington, Spalding, Lincs, PE11 4TA
01775 823000
www.georgebarnsdale.co.uk

ELEVATIONS
Type L204 - Outside View
(Scale 1:40)

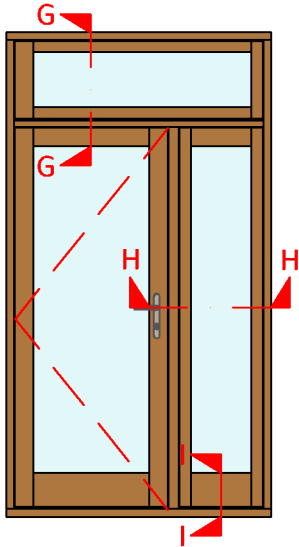

SECTIONS
Section G-G - (Scale 1:2)

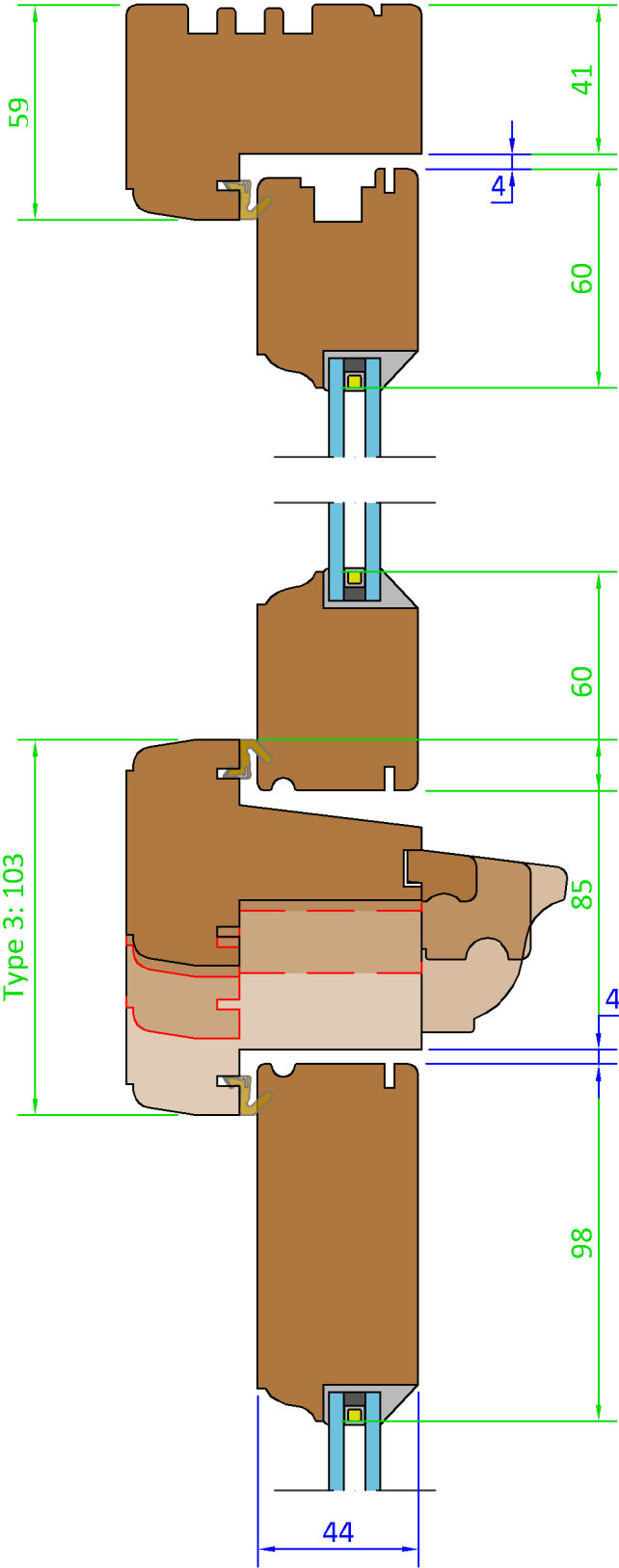

Section H-H - (Scale 1:2)

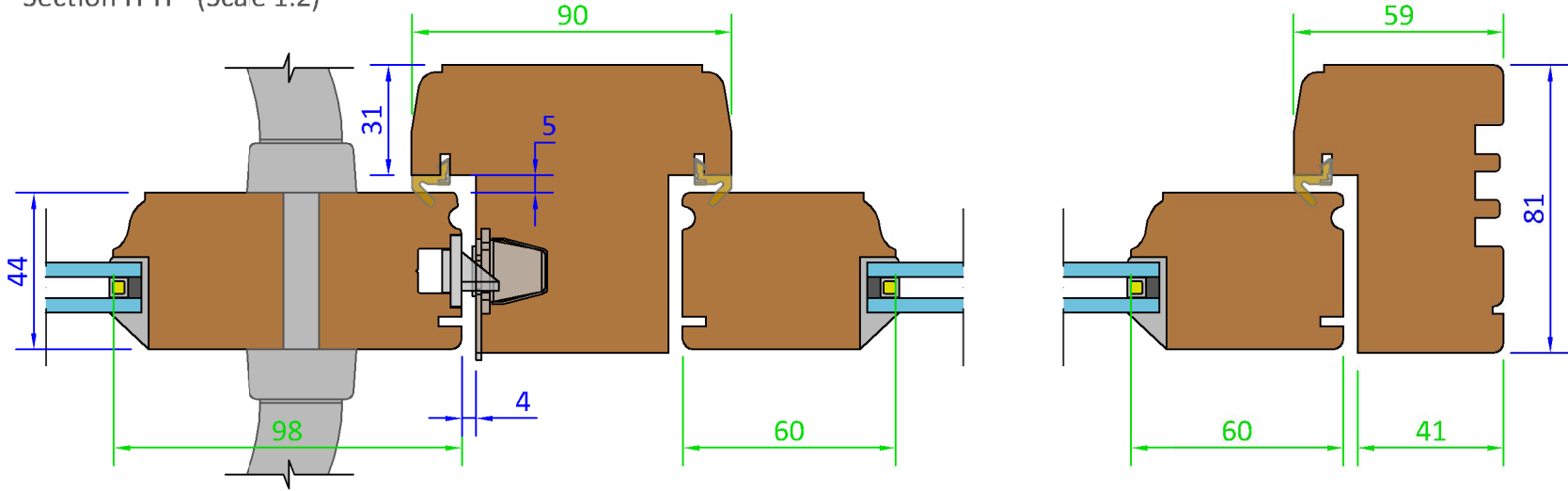

Section I - I - (Scale 1:2)

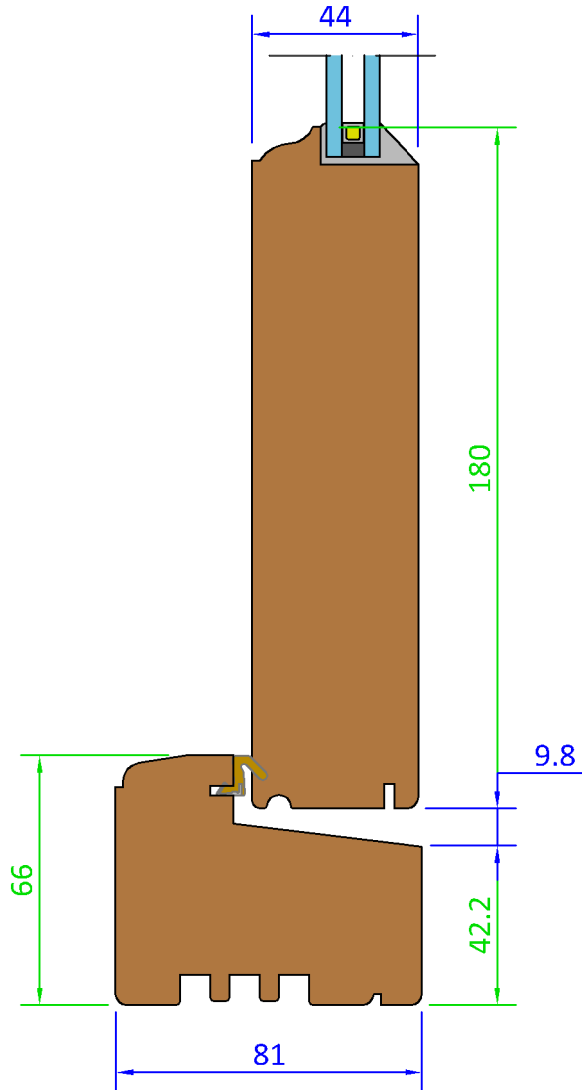

Variable Dimensions
(Dim shown is usually min)

Fixed Dimensions

Tolerances: All tolerances are to George Barnsdale Standard Tolerance definitions (see supporting document for more detail) unless stated on the drawing.
© George Barnsdale & Sons Ltd. All rights reserved. No part of this drawing may be reproduced without the permission of George Barnsdale & Son Ltd.

System: H-DS5-81-44		
Title: Historic Slim - Out Open Doorset (44mm)		
Scale:	As Shown	Rev No: B
Drawn By:	LH	Sheet No: 2
		Date: 14-Mar-18
		Status: Released

FRAME OPTIONS

Frame and Sash Options - (Scale 1:2)

81mm Frame - Standard Profile

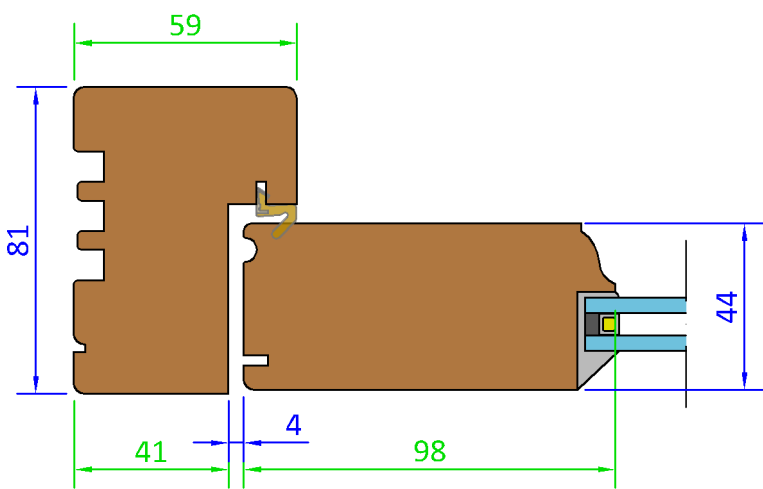

81mm Frame - Pencil Round Profile

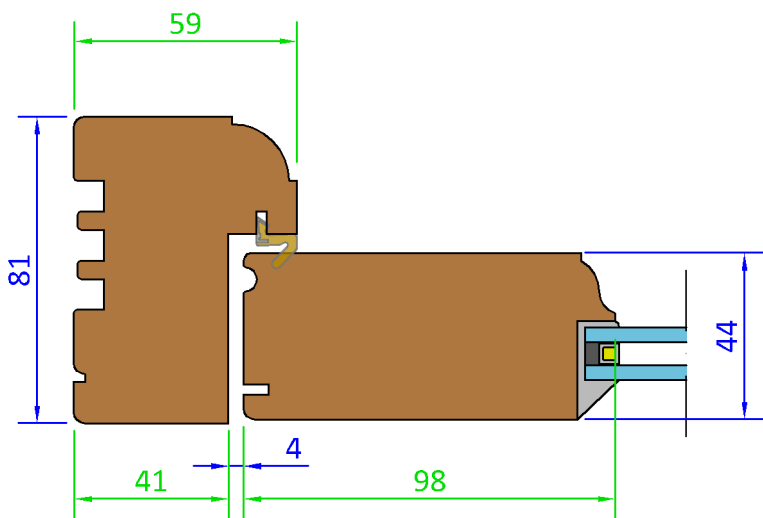

81mm Frame - Ovolo Profile

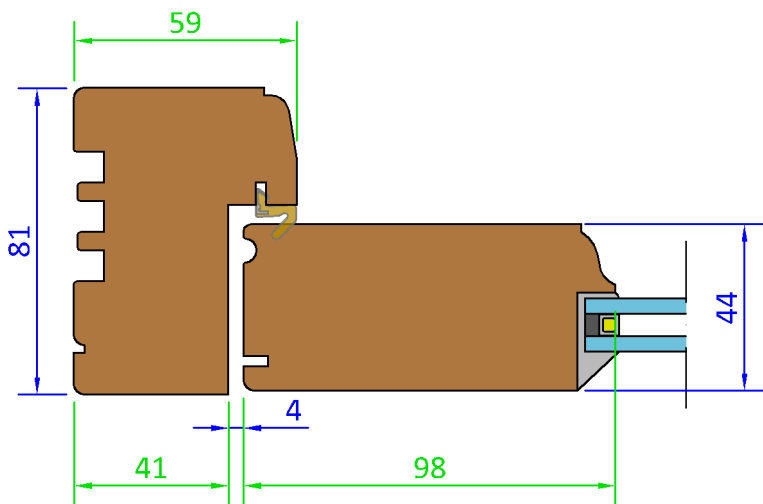

Cill Extension Options - (Scale 1:2)

Cill Extension For 35 mm Extension

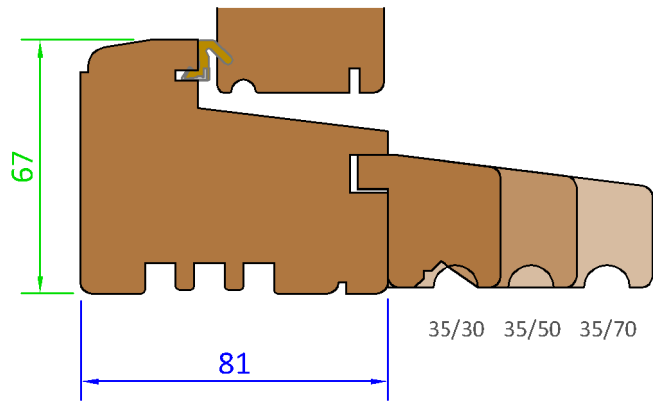

Cill Extension For 45 mm Extension

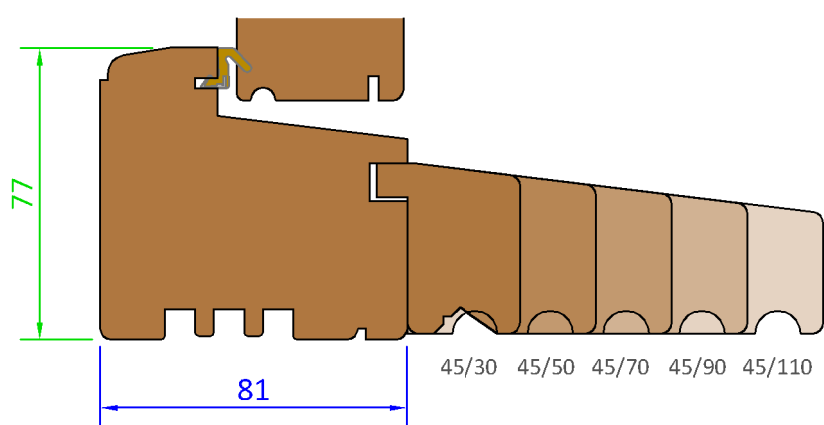

Low Threshold Option 1 - (Scale 1:2)

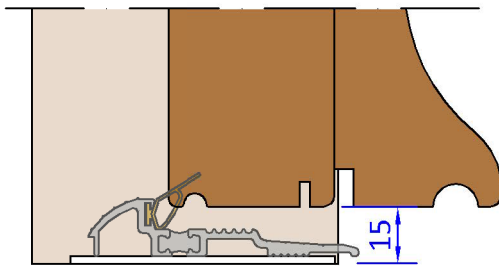

Water Bar Option - (Scale 1:2)

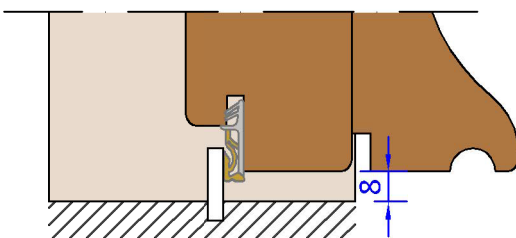

Drop-down Seal Option - (Scale 1:2)

Single Doors Only

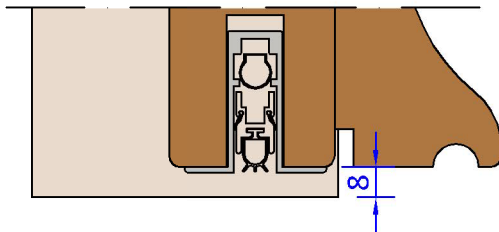

Variable Dimensions
(Dim shown is usually min)

Fixed Dimensions

Tolerances: All tolences are to George Barnsdale Standard Tolerance definitions (seupporting document for more detail) unless stated on the drawing.
© George Barnsdale & Sons Ltd. All rights reserved. No part of this drawing may be reproduced without the permission of George Barnsdale & Son Ltd.

System: H-DS5-81-44		
Title: Historic Slim - Out Open Doorset (44mm)		
Scale:	As Shown	Rev No: B
Drawn By:	LH	Sheet No: 3
		Date: 14-Mar-18
		Status: Released

**GEORGE
BARNSDALE**
Est. 1884
High Street, Donington, Spalding, Lincs, PE11 4TA
01775 823000
www.georgebarnsdale.co.uk

French Doors - Outside View (Scale 1:40)

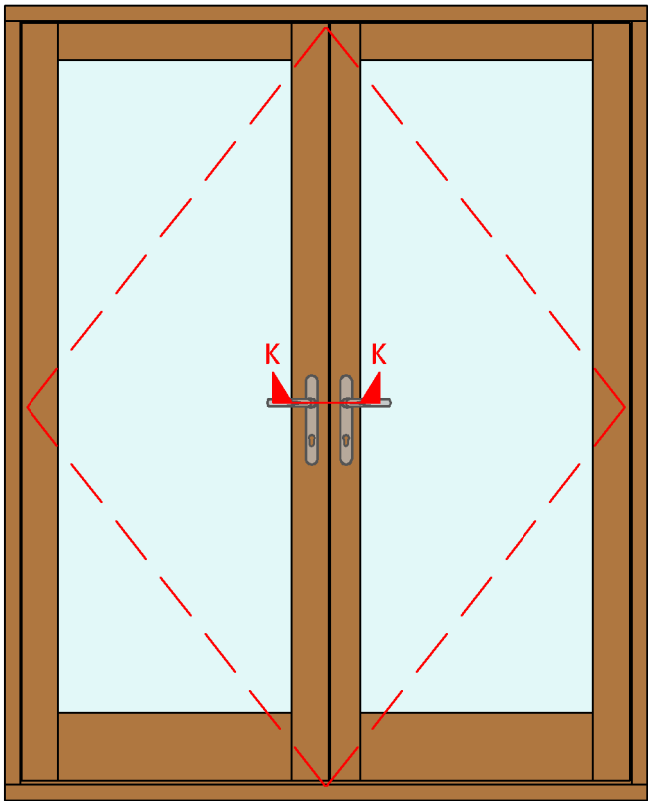

Meeting Rail Options

Stable Door Meeting J-J (Scale 1:2)

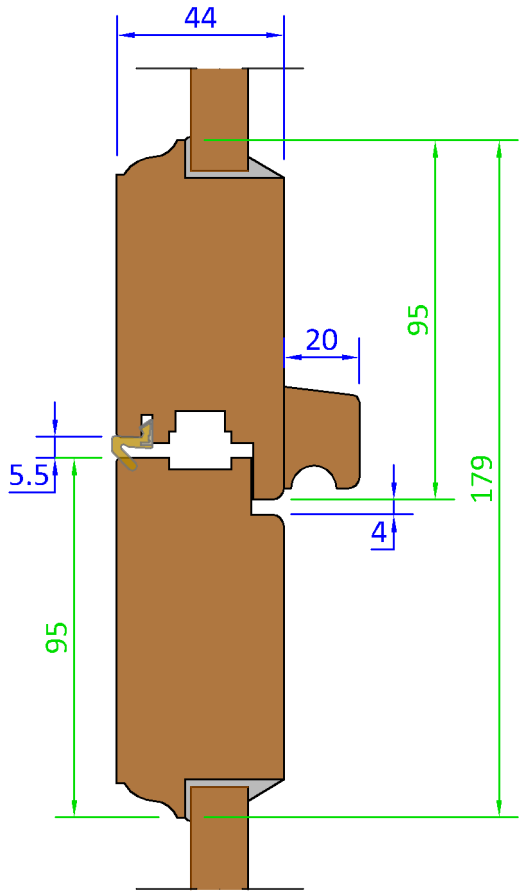

Section K-K French Door Meeting Concealed Lock Option - (Scale 1:2)

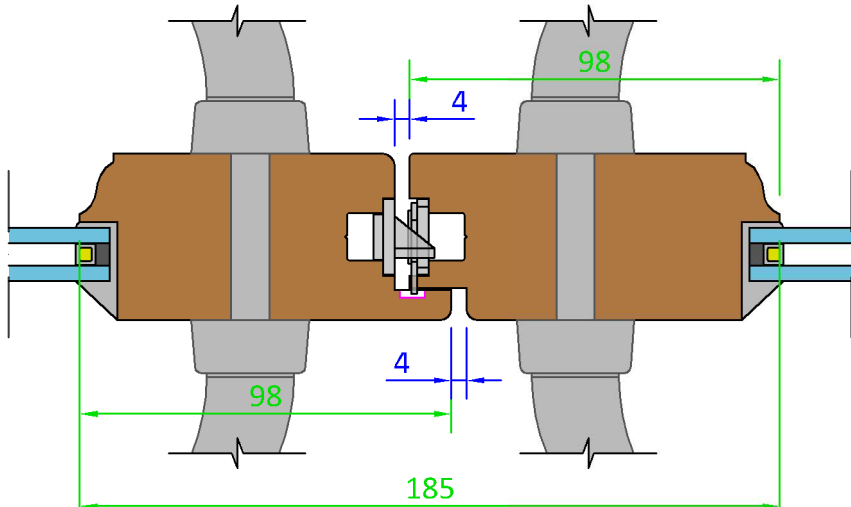

Section K-K French Door Meeting ThumbBolt Option - (Scale 1:2)

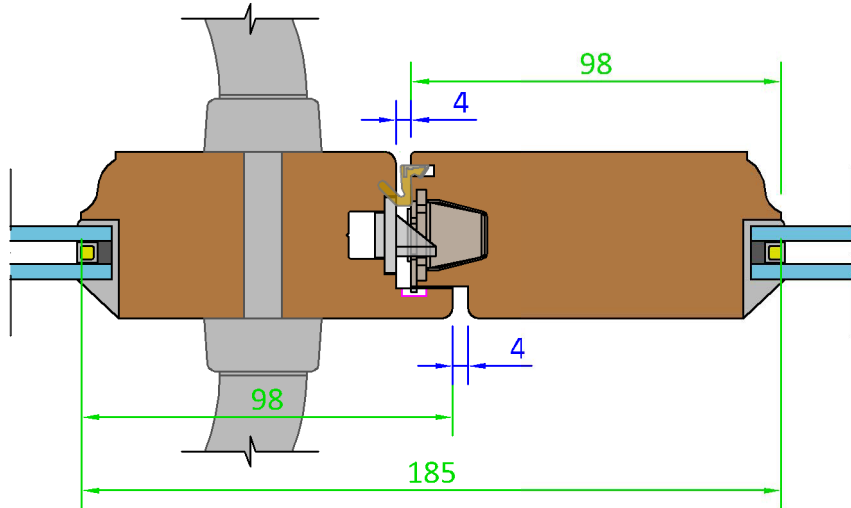

Section K-K French Door Meeting - (Scale 1:2)

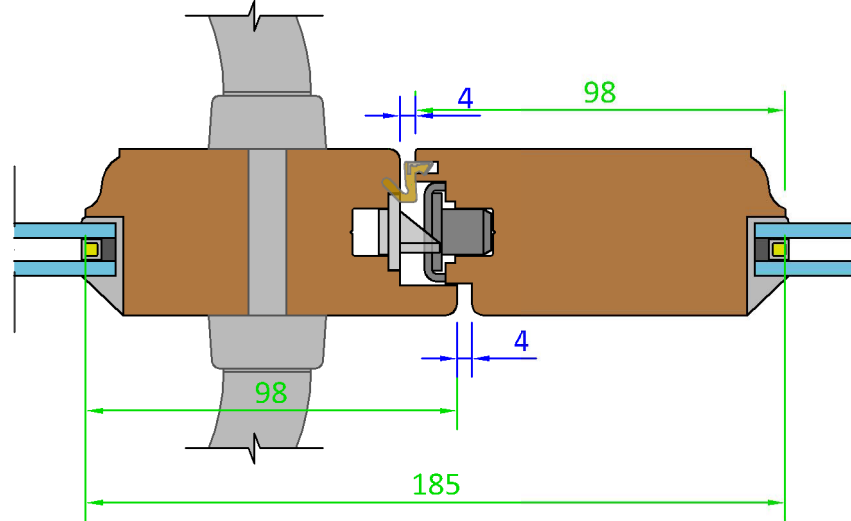

Stable Door - Outside View (Scale 1:40)

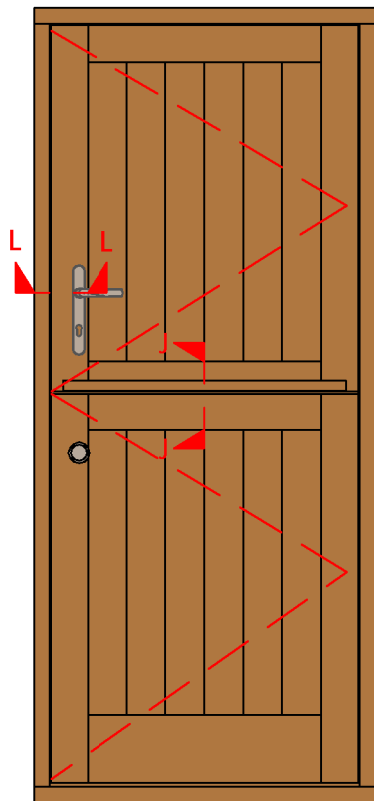

Stable Door Handle L-L (Scale 1:2)

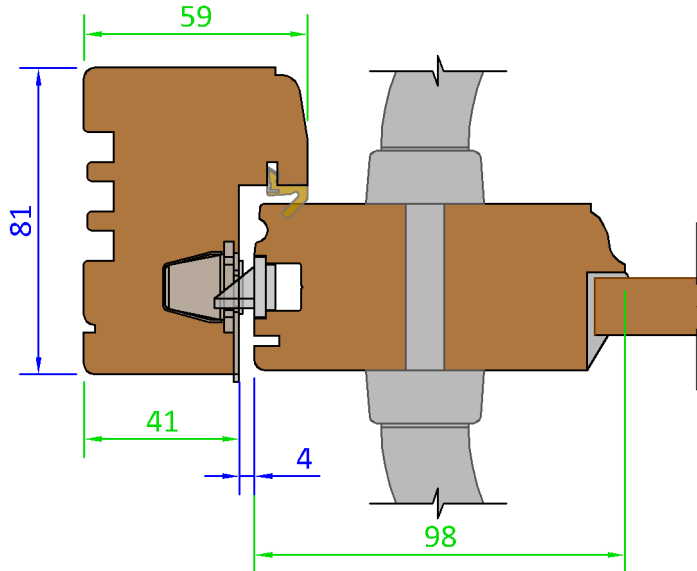

Variable Dimensions
(Dim shown is usually min)

Fixed Dimensions

Tolerances: All tolerances are to George Barnsdale Standard Tolerance definitions (see supporting document for more detail) unless stated on the drawing.
© George Barnsdale & Sons Ltd. All rights reserved. No part of this drawing may be reproduced without the permission of George Barnsdale & Son Ltd.

System: H-DS5-81-44			
Title: Historic Slim - Out Open Doorset (44mm)			
Scale:	As Shown	Rev No:	B
Drawn By:	LH	Sheet No:	4
		Date:	14-May-18
		Status:	Released

**GEORGE
BARNSDALE**
Est. 1884
High Street, Donington, Spalding, Lincs, PE11 4TA
01775 823000
www.georgebarnsdale.co.uk

VENTILATION OPTION DETAILS

Head Drip Option - (Scale 1:2)

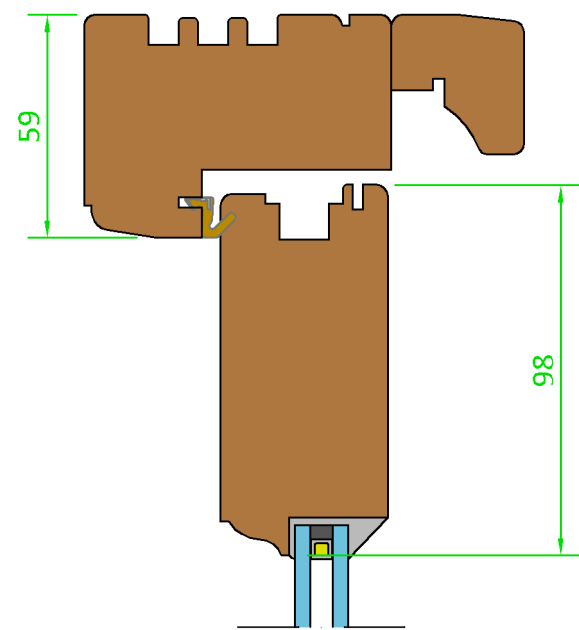

Frame Vent V1 (Slidein/Grille Out) - (Scale 1:2)

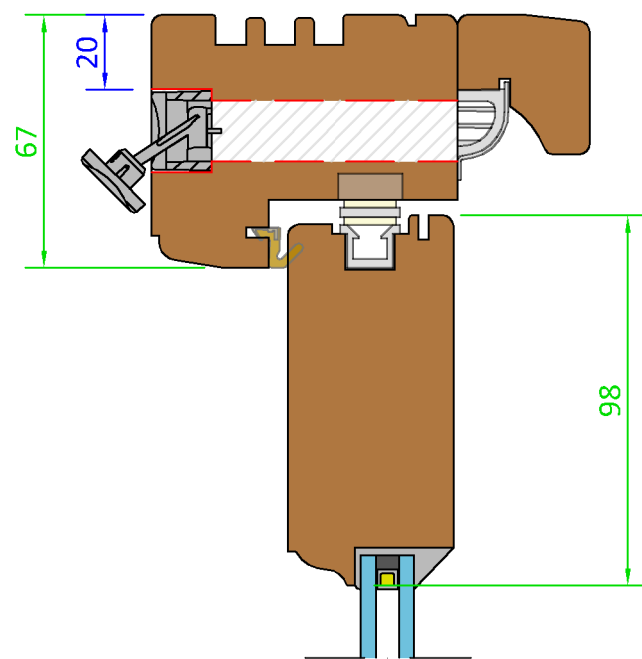

Frame Vent V2 (Slide in/Canopy Out)- (Scale 1:2)

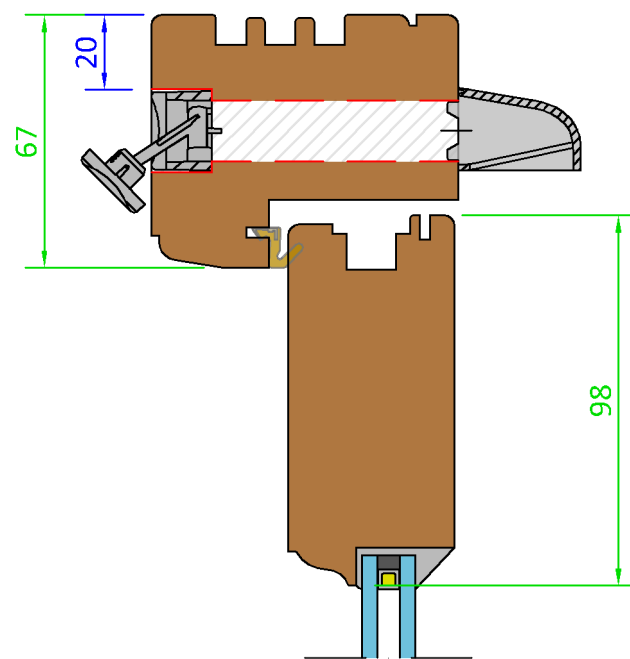

Sash Vent Type 1 (Slide In/Canopy Out) - (Scale 1:2)

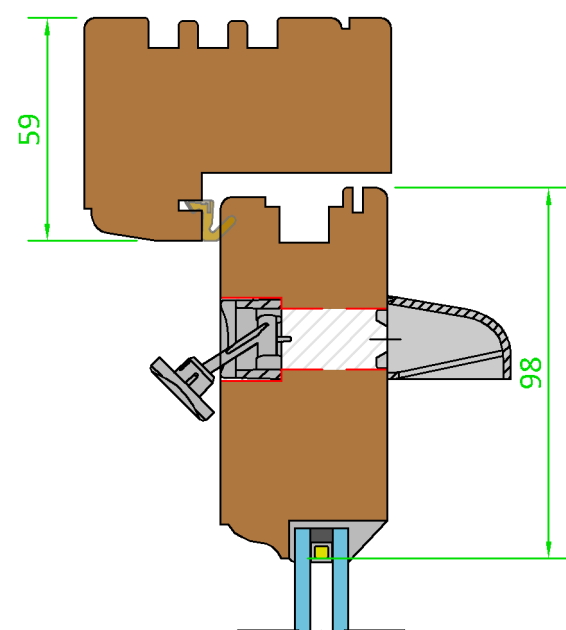

Tolerances: All tolerances are to George Barnsdale Standard Tolerance definitions (see supporting document for more detail) unless stated on the drawing.
© George Barnsdale & Sons Ltd. All rights reserved. No part of this drawing may be reproduced without the permission of George Barnsdale & Son Ltd.

System: H-DS5-81-44		
Title: Historic Slim - Out Open Doorset (44mm)		
Scale:	Rev No:	Date:
As Shown	B	14-Mar-18
Drawn By:	Sheet No:	Status:
LH	5	Released

BAY CONNECTION DETAILS - (Scale 1:2)

90° Corner Post

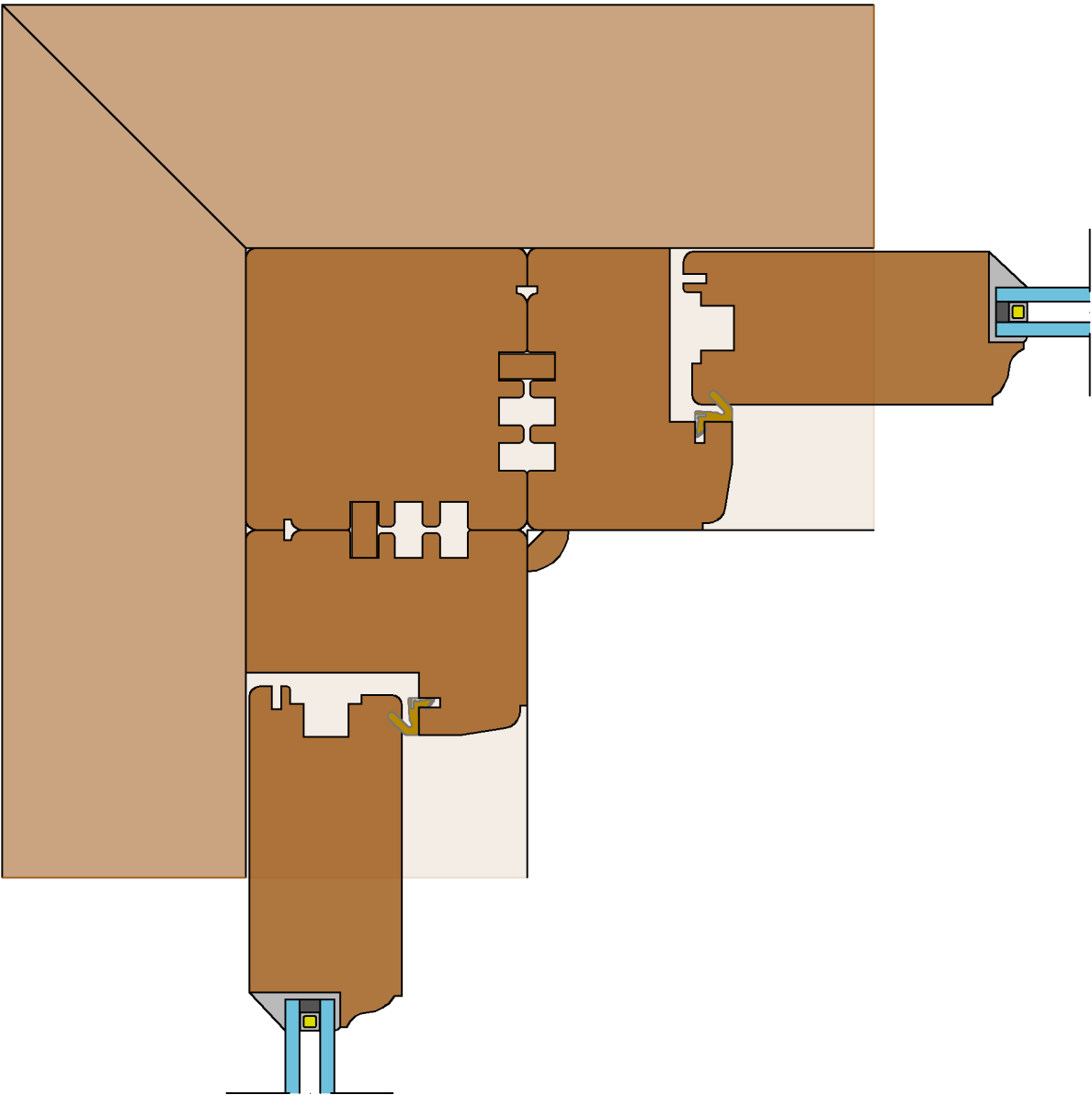

91-155° Angled Corner Post

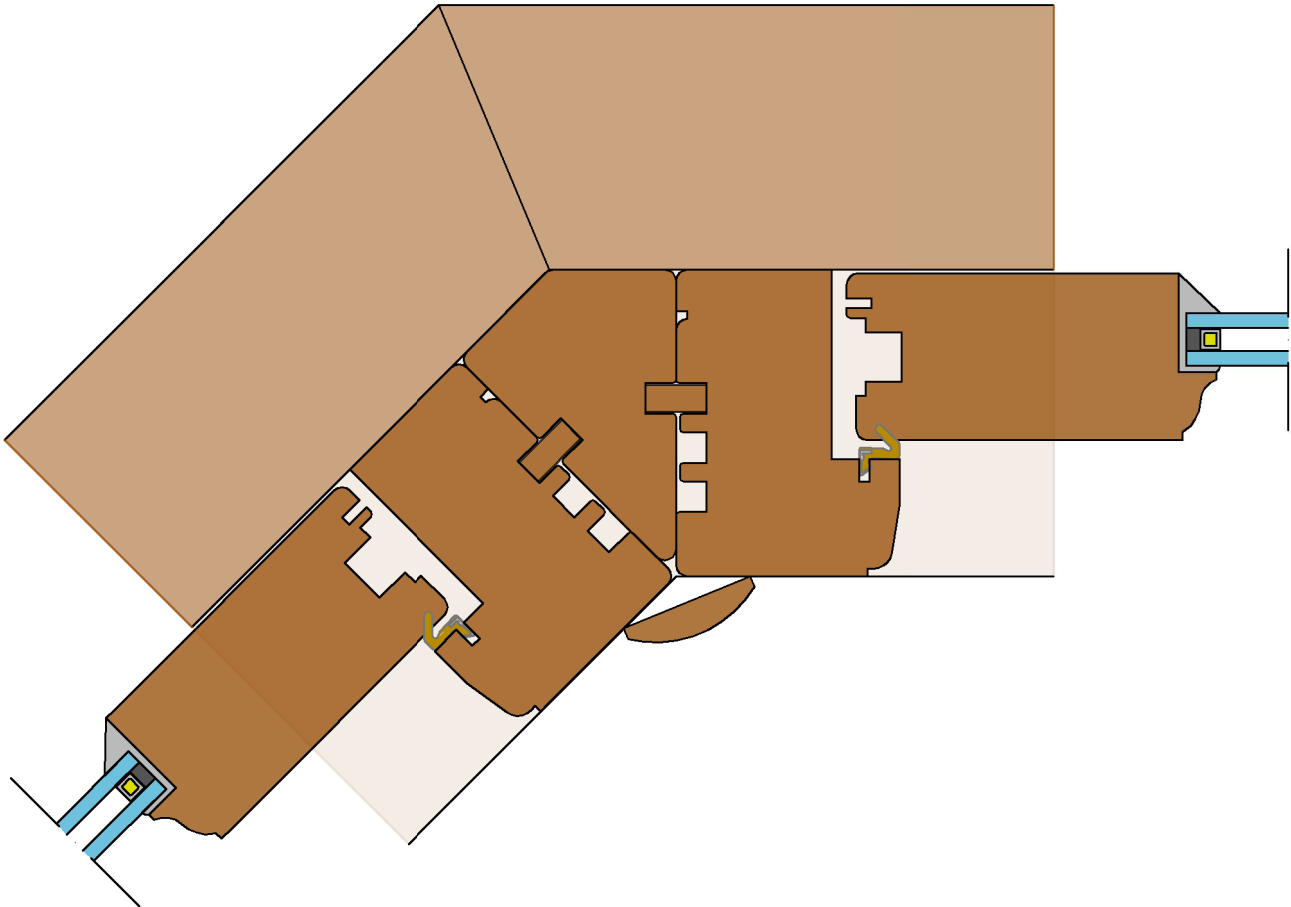

156-179° Segmented Bay

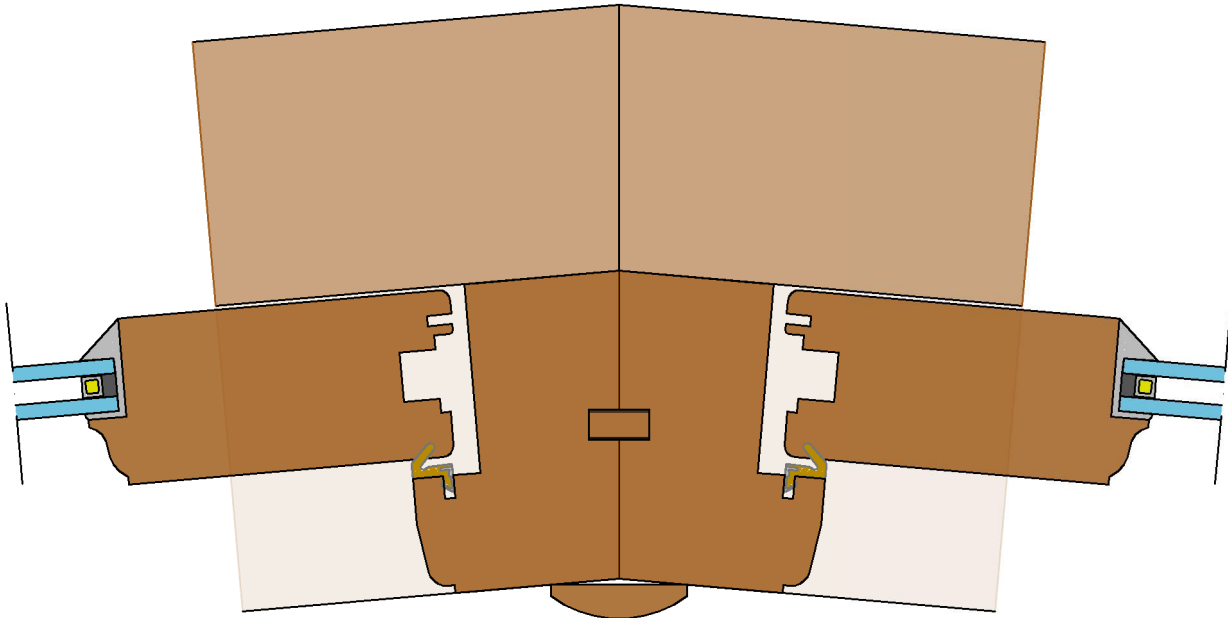

 Vent System

System: H-DS5-81-44			
Title: Historic Slim - Out Open Doorset (44mm)			
Scale:	As Shown	Rev No:	B
Drawn By:	LH	Sheet No:	6
		Date:	14-Mar-18
		Status:	Released

**GEORGE
BARNSDALE**
Est. 1884
High Street, Donington, Spalding, Lincs, PE11 4TA
01775 823000
www.georgebarnsdale.co.uk

Tolerances: All tolerances are to George Barnsdale Standard Tolerance definitions (see supporting document for more detail) unless stated on the drawing.
© George Barnsdale & Sons Ltd. All rights reserved. No part of this drawing may be reproduced without the permission of George Barnsdale & Son Ltd.

STANDARD DOOR TYPE (Scale 1:30)

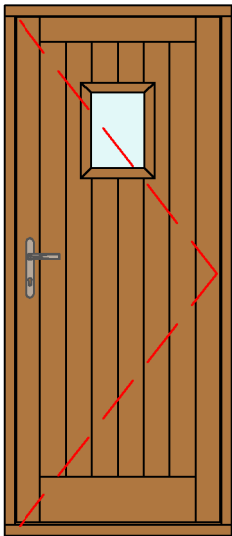

Type 101
(With Vision Panel)

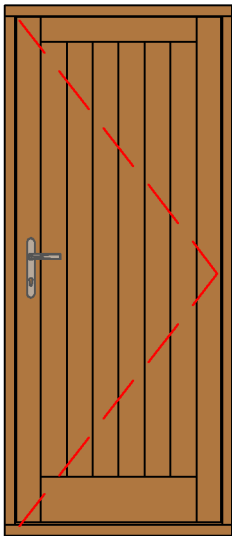

Type 101

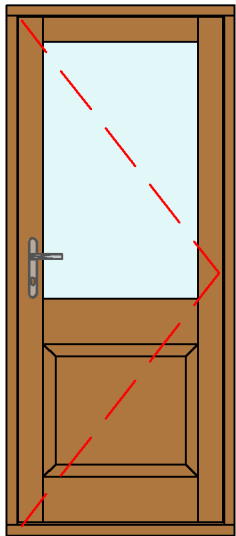

Type 102

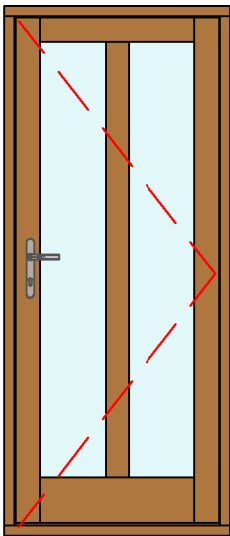

Type 103

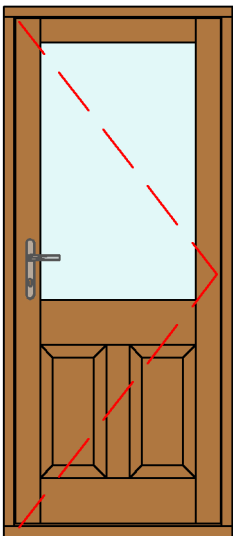

Type 104

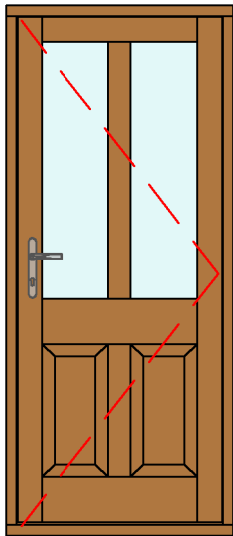

Type 105

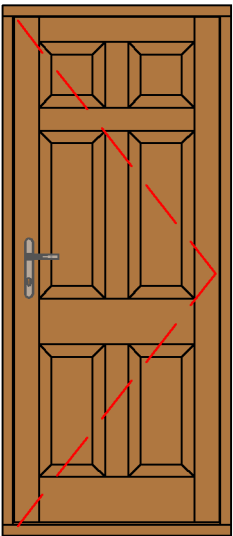

Type 106

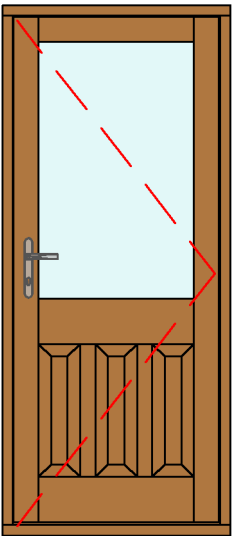

Type 107

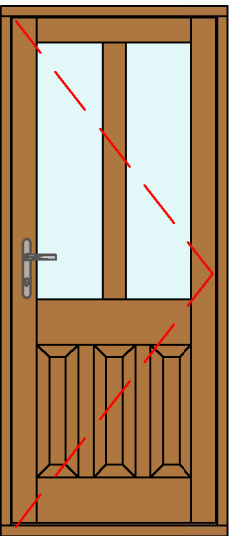

Type 108

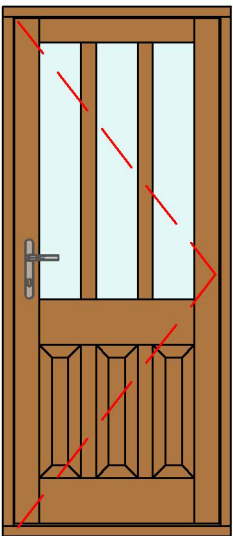

Type 109

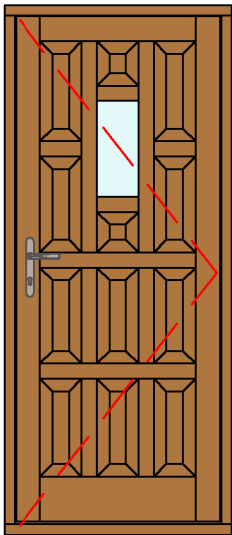

Type 157

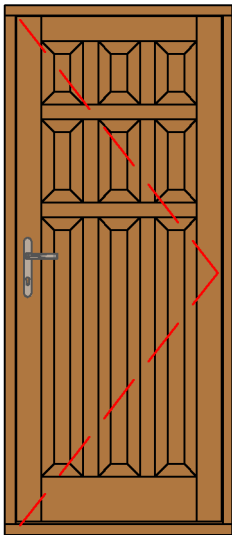

Type 110

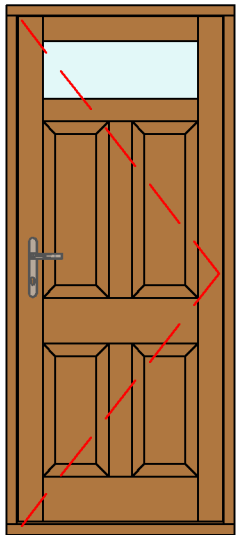

Type 111

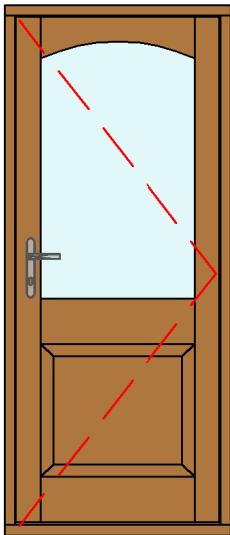

Type 120

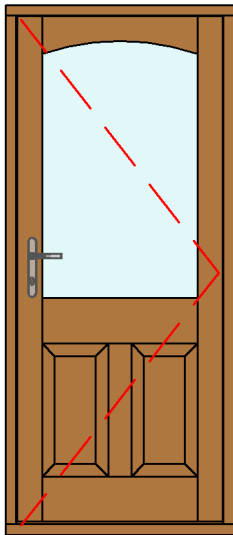

Type 121

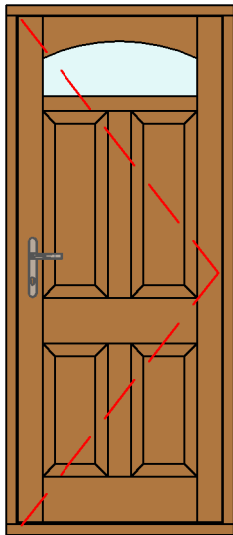

Type 122

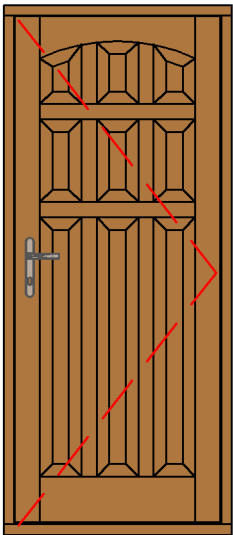

Type 123

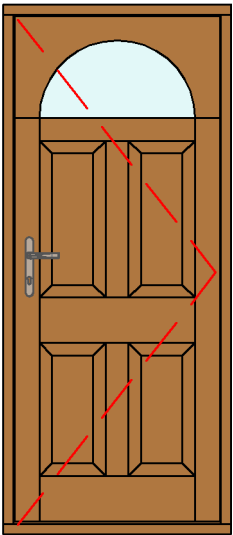

Type 140

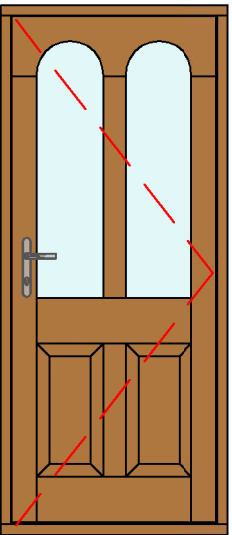

Type 141

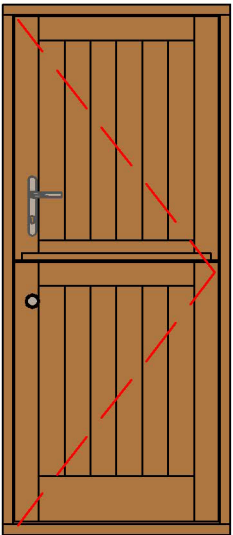

Type Stable

Tolerances: All tolerances are to George Barnsdale Standard Tolerance definitions (see supporting document for more detail) unless stated on the drawing.
© George Barnsdale & Sons Ltd. All rights reserved. No part of this drawing may be reproduced without the permission of George Barnsdale & Son Ltd.

System: H-DS5-81-44		
Title: Historic Slim - Out Open Doorset (44mm)		
Scale:	As Shown	Rev No: B
Drawn By:	LH	Sheet No: 7
		Date: 14-Mar-18
		Status: Released

GEORGE
BARNSDALE

Est. 1884

High Street, Donington, Spalding, Lincs, PE11 4TA
01775 823000
www.georgebarnsdale.co.uk

STANDARD DOOR TYPE (Scale 1:40)

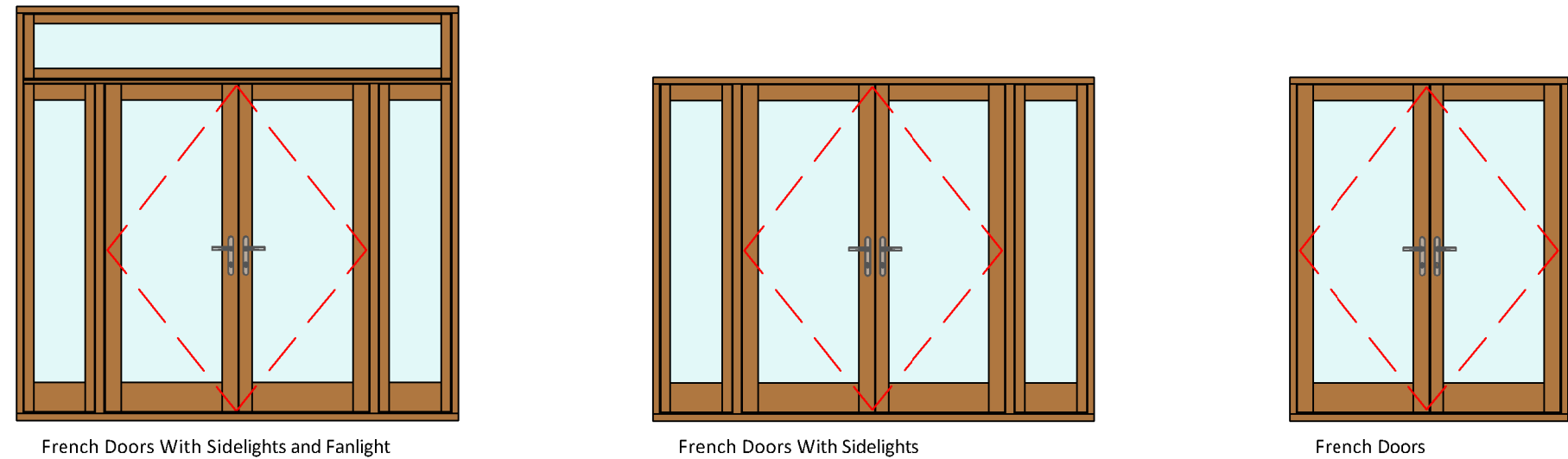
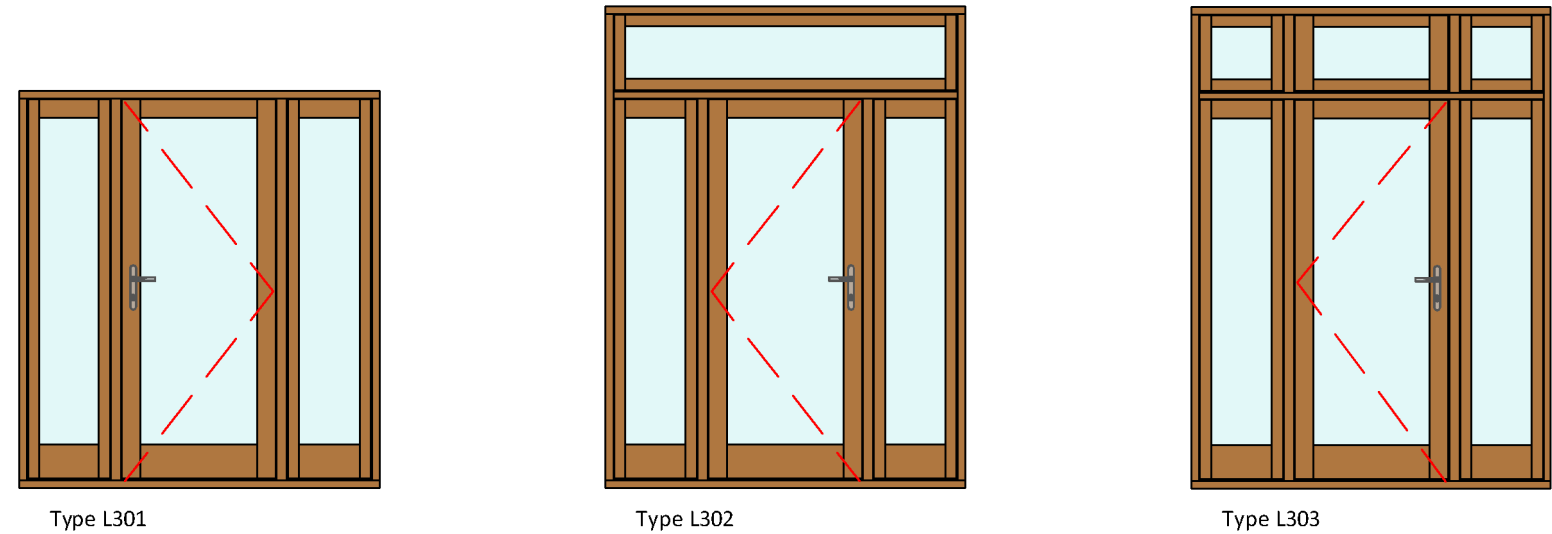
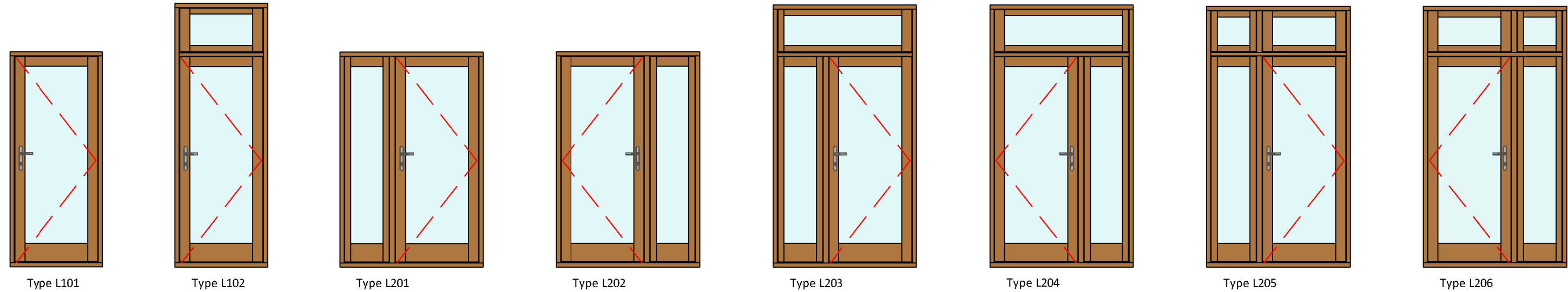

Tolerances: All tolences are to George Barnsdale Standard Tolerance definitions (se:upporting document for more detail) unless stated on the drawing.
© George Barnsdle & Sons Ltd. All rights reserved. No part of this drawing may beproduced without the permission of George Barnsdale & Son Ltd.

System: H-DS5-81-44		
Title: Historic Slim - Out Open Doorset (44mm)		
Scale:	As Shown	Rev No: B
Drawn By:	LH	Sheet No: 8
		Date: 14-Mar-18
		Status: Released