

ELEVATIONS
(All details 1:20)

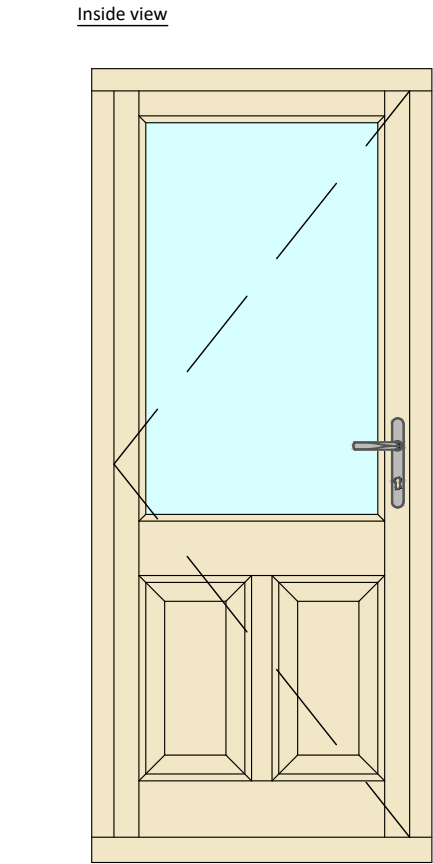

Section A-A - Head detail

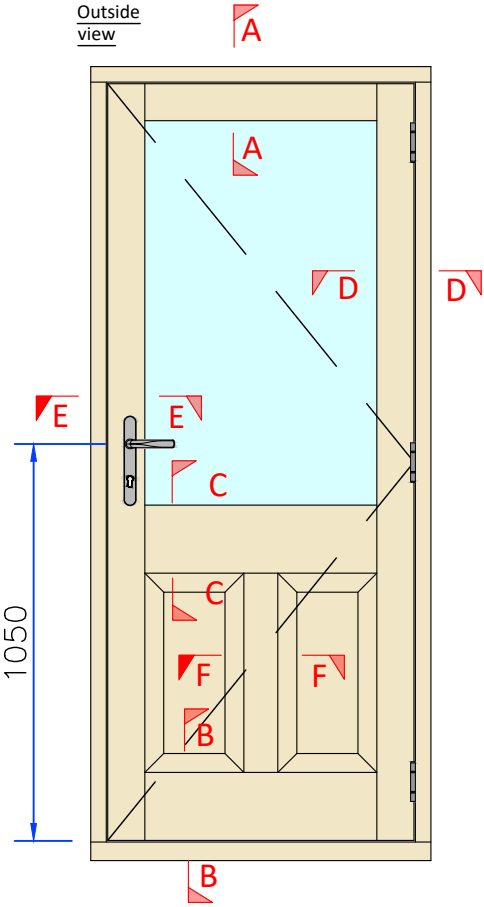
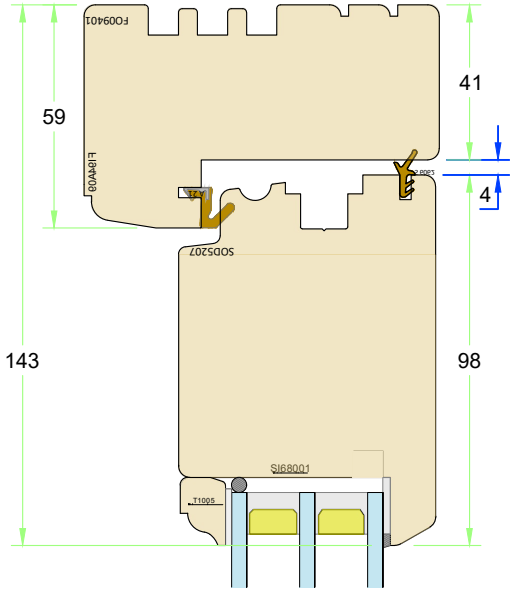

Section B-B - Cill detail

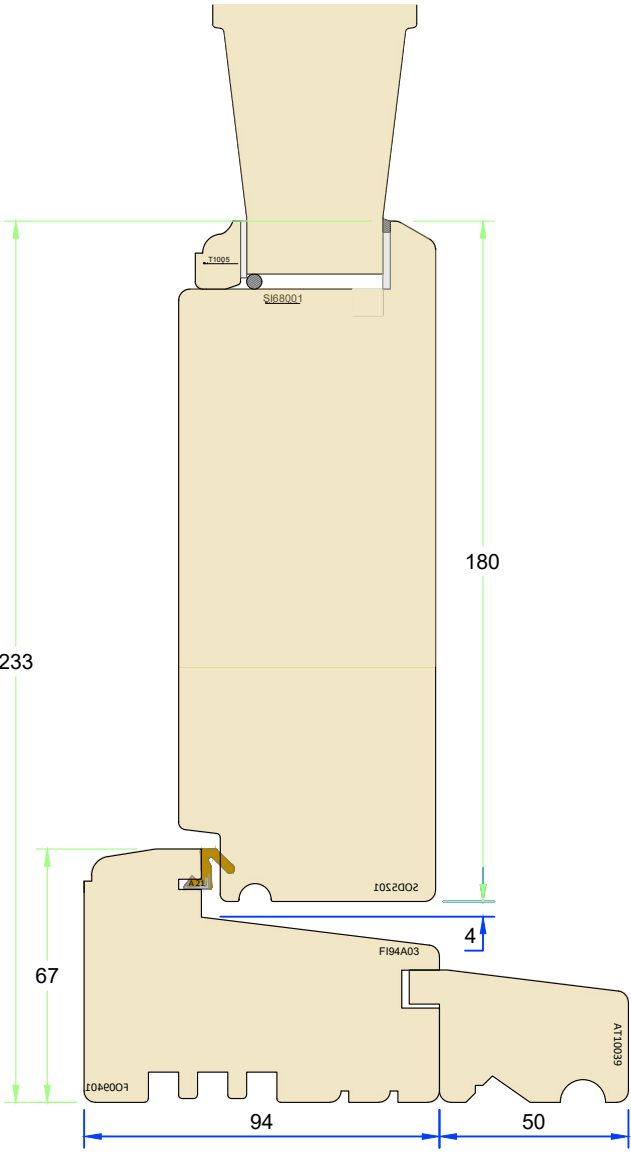

Section C-C - Midrail

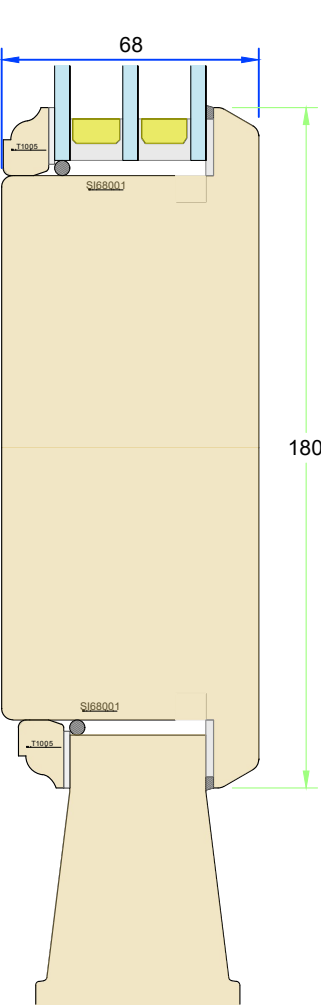

Section E-E - Jamb and lock

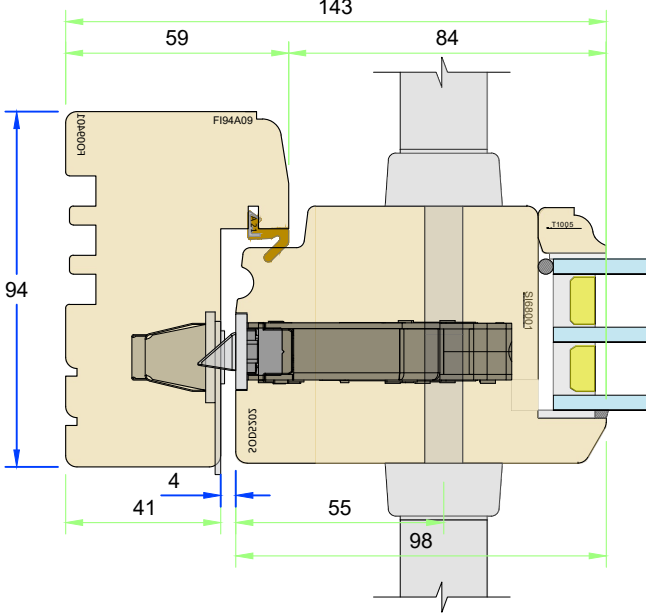

Section D-D - Hinge detail

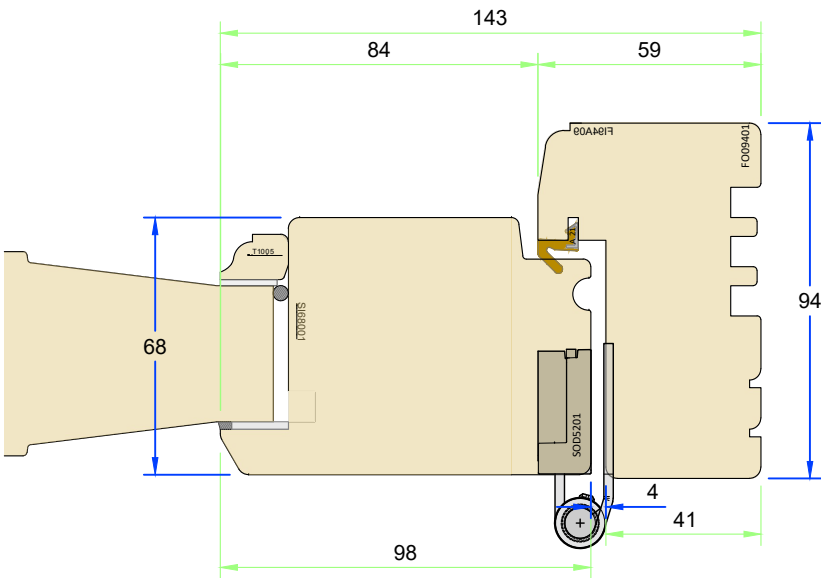

Section F-F - Vertical rail

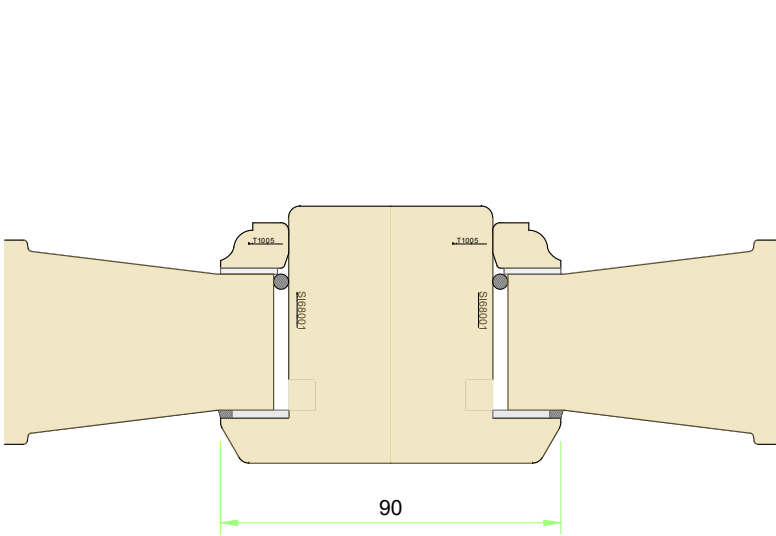

olerances are to George Barnsdale Standard Tolerance definitions (see supporting document for more detail) unless stated on the drawing.
ale & Sons Ltd. All rights reserved. No part of this drawing may be reproduced without the permission of George Barnsdale & Son Ltd.

SECTIONS
(All details 1:2)

Variable Dimensions
(Dim shown is usually min)

Fixed Dimensions

Localised routing

| | | | |
|--|----------|------|----------------|
| Part No. T-DS5-94-68 | | | |
| Title: Traditional plus - Outward opening doorset (68mm) | | | |
| Scale: | As shown | Rev: | Date: 19.12.24 |
| Drawn By: | MKH | No.: | T-DS5-94-68-1 |

**GEORGE
BARNSDALE**
Est. 1884
High Street, Donington, Spalding, Lincs, PE11 4TA
01775 823000
www.georgebarnsdale.co.uk

LOW THRESHOLD OPTIONS
(All details 1:2)

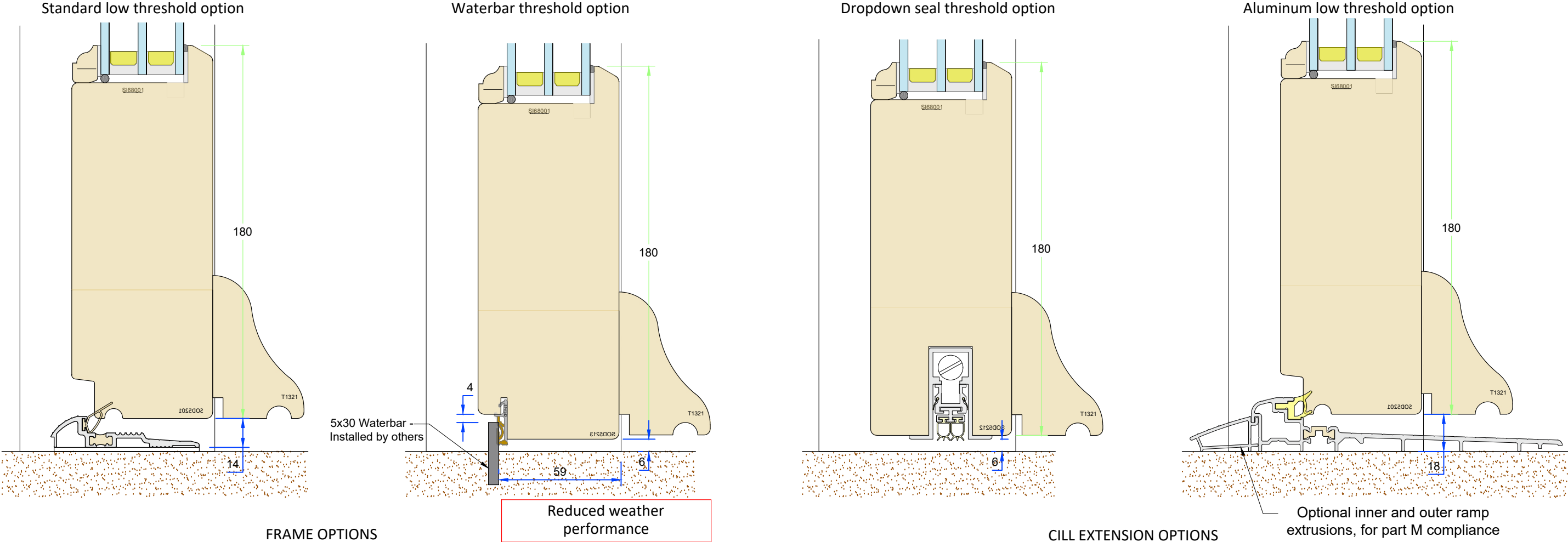

FRAME OPTIONS
(All details 1:2)

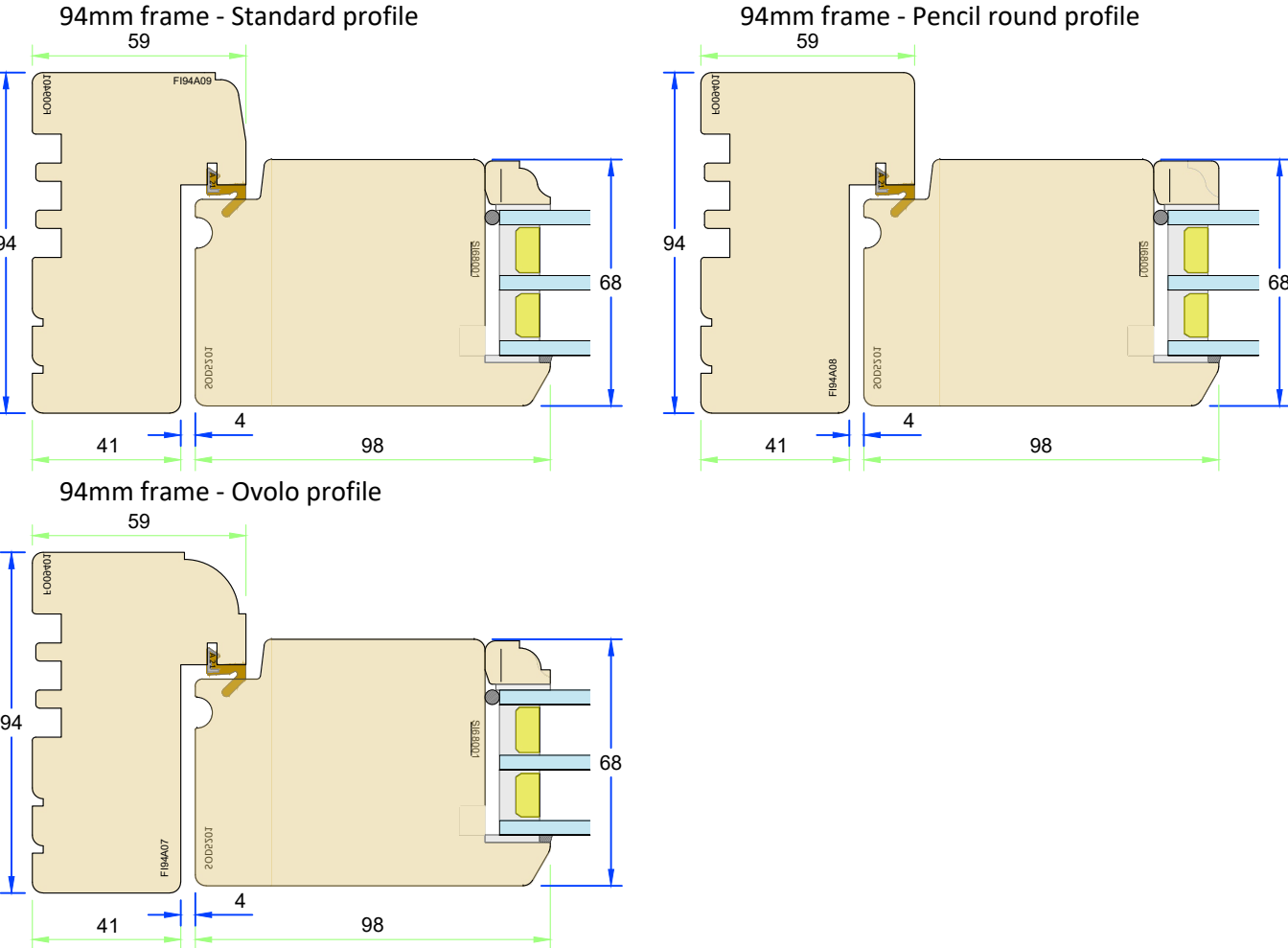

CILL EXTENSION OPTIONS
(All details 1:2)

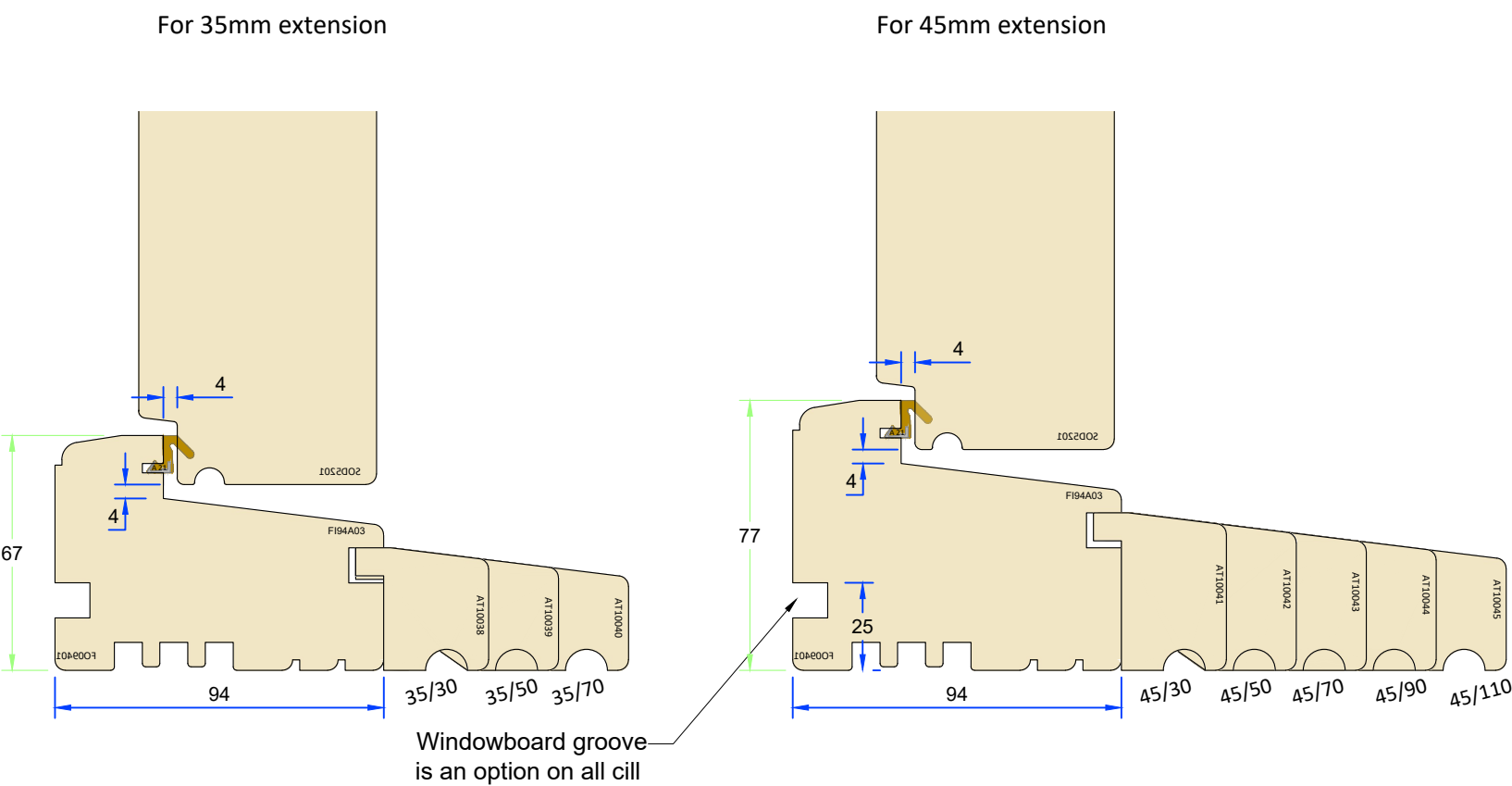

olerances are to George Barnsdale Standard Tolerance definitions (see supporting document for more detail) unless stated on the drawing.
ale & Sons Ltd. All rights reserved. No part of this drawing may be reproduced without the permission of George Barnsdale & Son Ltd.

Variable Dimensions
(Dim shown is usually min)

Fixed Dimensions

Localised routing

| | | |
|--|------|----------------|
| Part No. T-DS5-94-68 | | |
| Title: Traditional plus - Outward opening doorset (68mm) | | |
| Scale: As shown | Rev: | Date: 19.12.24 |
| Drawn By: MKH | No.: | T-DS5-94-68-2 |

GEORGE
BARNSDALE

Est. 1884

High Street, Donington, Spalding, Lincs, PE11 4TA

01775 823000

www.georgebarnsdale.co.uk

(All details 1:20)

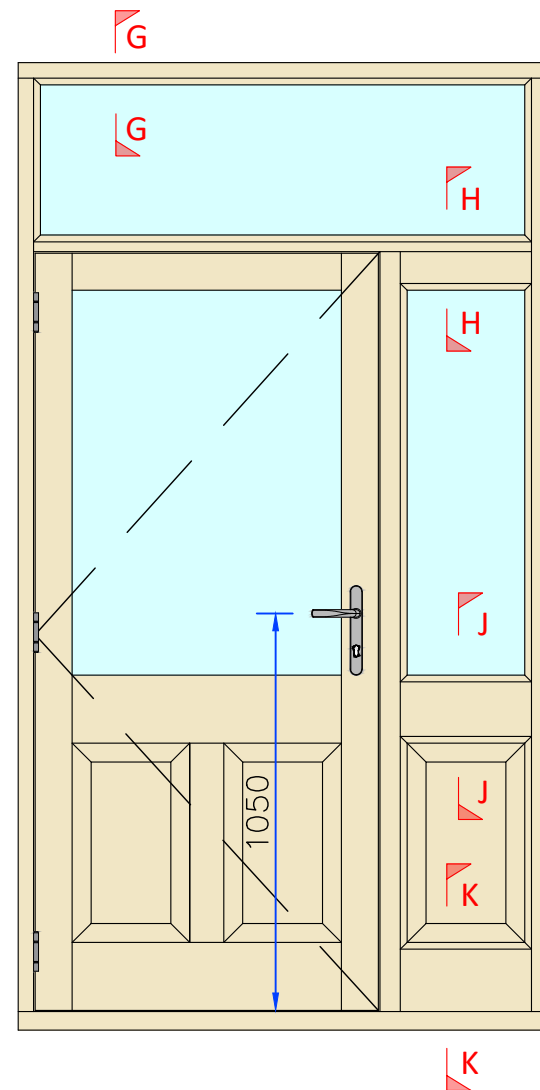

(All details 1:2)

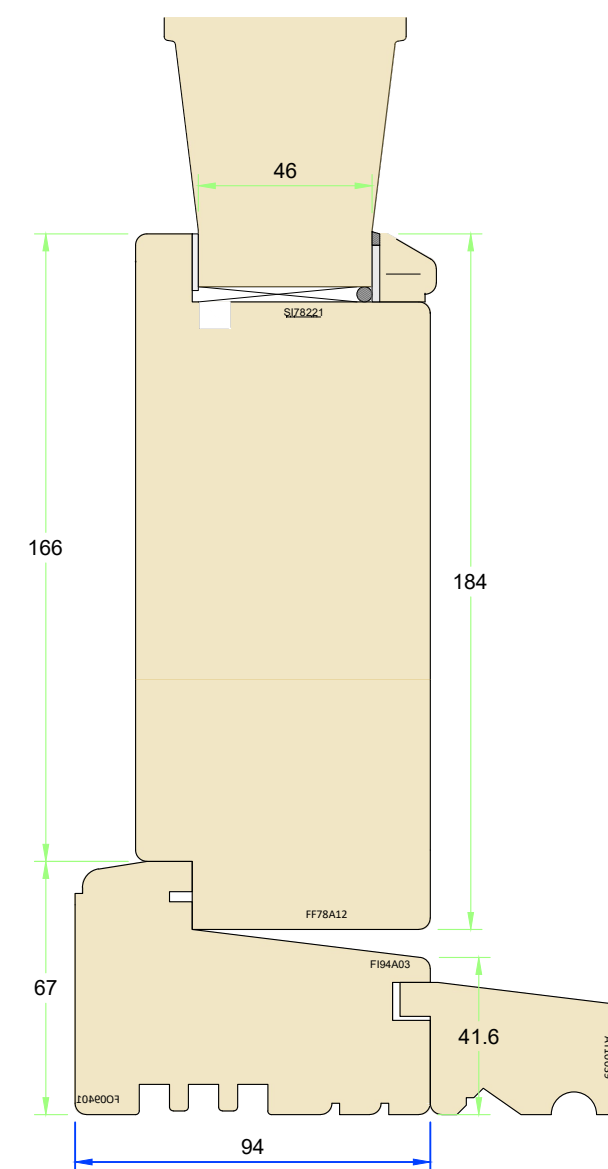
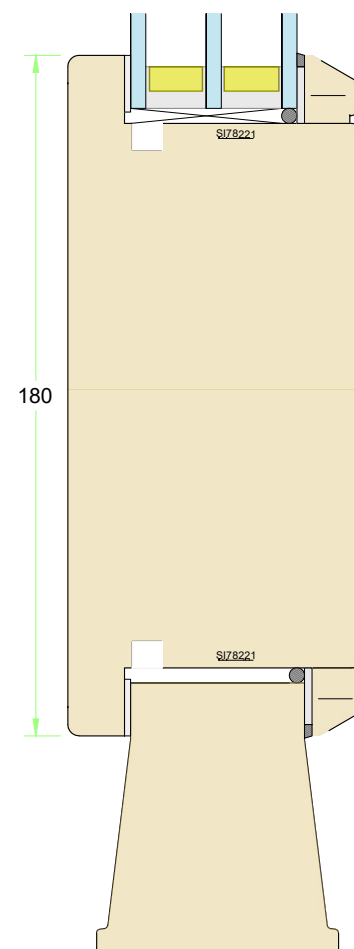
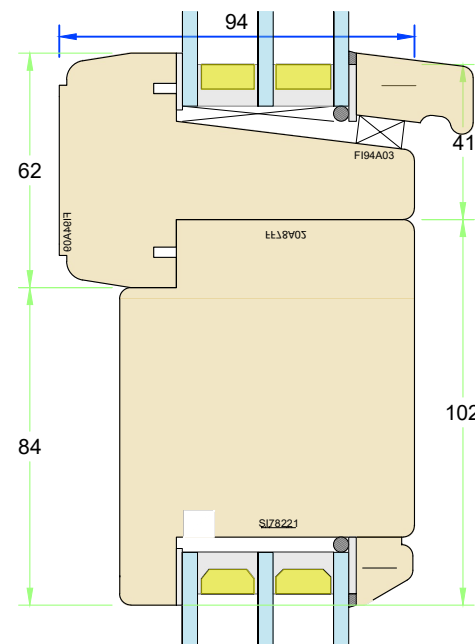
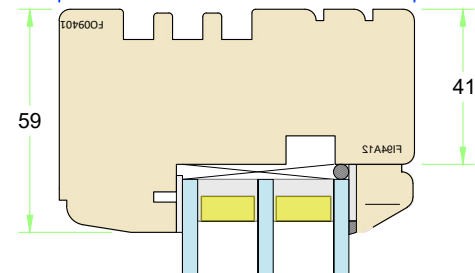

tolerances are to George Barnsdale Standard Tolerance definitions (see supporting document for more detail) unless stated on the drawing.
George Barnsdale & Son Ltd. All rights reserved. No part of this drawing may be reproduced without the permission of George Barnsdale & Son Ltd.

Technical drawing of a mechanical part, likely a bracket or support, showing dimensions and labels. The part is shown in a cross-sectional view, revealing internal features and a mounting hole.

Dimensions:

- Overall width: 94
- Overall height: 59
- Height of the upper section: 41
- Height of the lower section: 60
- Height of the mounting hole: 4

Labels:

- F0094013 (Top left)
- 20C5311 (Middle right)
- S158201 (Bottom right)

The drawing includes a cross-section of the part, showing internal features and a mounting hole. The part is shown in a cross-sectional view, revealing internal features and a mounting hole.

Technical drawing of a mechanical part, likely a bracket or support, showing dimensions and labels.

Dimensions:

- Overall width: 68
- Overall height: 98
- Top section height: 60
- Bottom section height: 4
- Distance from top to first horizontal section: 82 (Type 2)
- Distance from top to second horizontal section: 65 (Type 1)
- Distance from top to third horizontal section: 62 (Standard)
- Distance from top to bottom section: 103 (Type 3)

Labels:

- Top section: SUE8001
- Second horizontal section: SUE8001
- Third horizontal section: SUE8001
- Bottom section: SUE8001
- Top right section: SUE8001
- Bottom right section: SUE8001
- Top right section: SUE8001
- Bottom right section: SUE8001
- Top right section: SUE8001
- Bottom right section: SUE8001

SECTIONS
(All details 1:2)

Technical drawing of the front view of a mechanical component. The drawing shows a central assembly with a horizontal shaft and a vertical shaft. Dimensions are indicated by green and blue lines. Key dimensions include a total width of 90, a central width of 54, and a total height of 68. Part numbers are labeled: F18A09, F19A09, S05202, S05212, and S05201. The drawing also shows a central shaft with a key and a vertical shaft with a key.

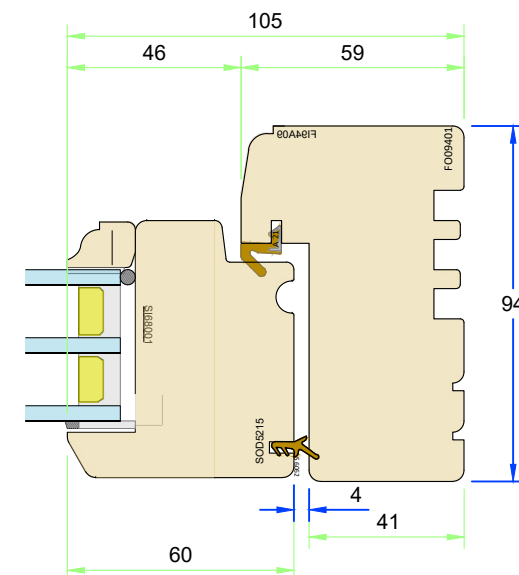

| | | |
|--|------------------------------|--------------------------|
| Part No. T-DS5-94-68 Title: Traditional plus - Outward opening doorset (68mm) | | |
| Scale: As shown | Rev: | Date: 19.12.24 |
| Drawn By: MKH | No.: T-DS5-94-68-4 | |

**GEORGE
BARNSDALE**
Est. 1884 —————
High Street, Donington, Spalding, Lincs, PE11 4TA
01775 823000
www.georgebarnsdale.co.uk

tolerances are to George Barnsdale Standard Tolerance definitions (see supporting document for more detail) unless stated on the drawing.
George Barnsdale & Son Ltd. All rights reserved. No part of this drawing may be reproduced without the permission of George Barnsdale & Son Ltd.

ELEVATIONS
(All details 1:20)

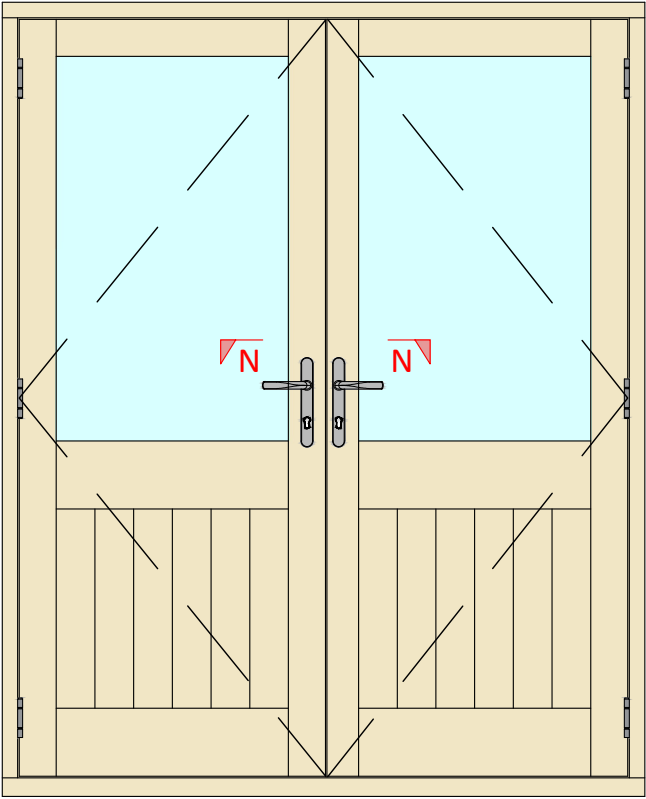

FRENCH DOOR OPTIONS
(All details 1:2)

Section N-N - French Meeting Rail Options

French Door Meeting
Sash height >
1830mm

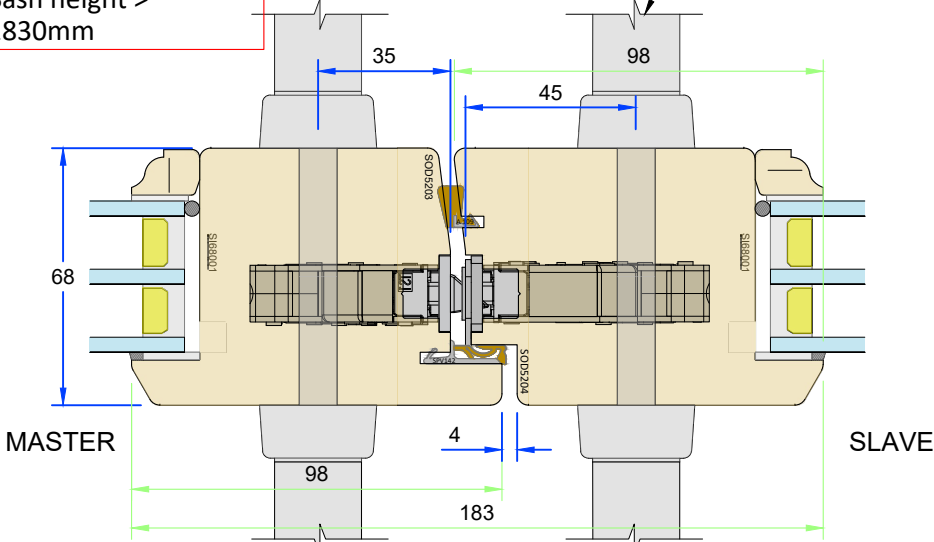

French door locking options

French Door Meeting Concealed Lock Option
Sash height > 1853mm

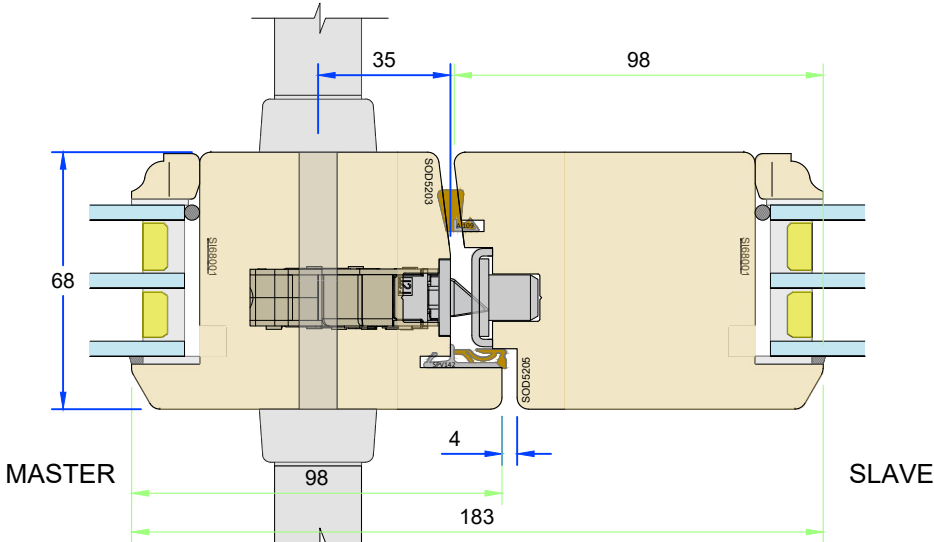

Thumb Bolt Lock Option
Sash height < 1853mm

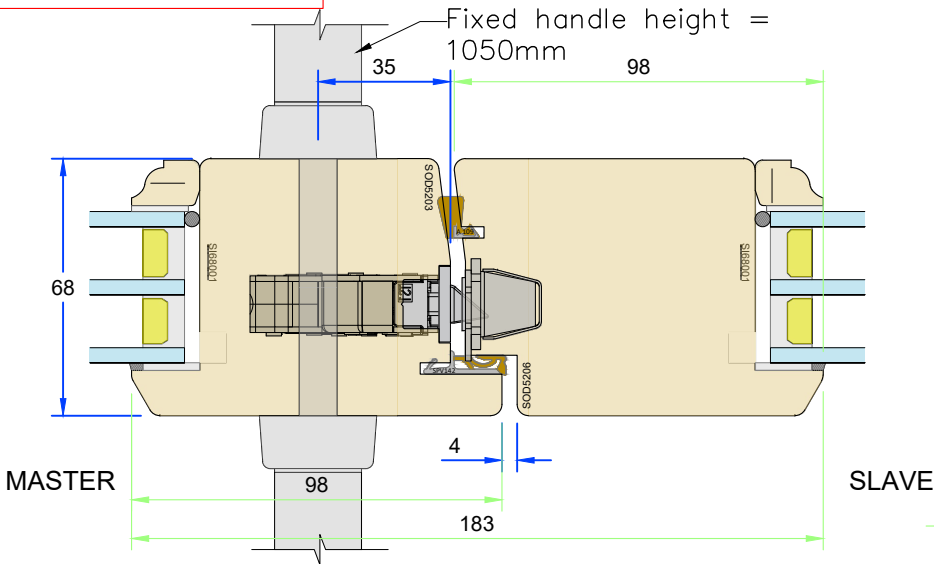

Section D-D - Concealed hinge option

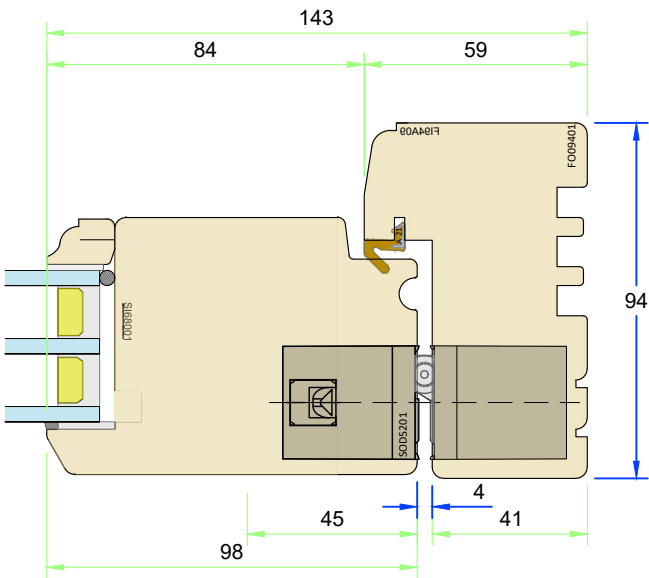

STABLE DOOR DETAILS
(All details 1:2)

Section P-P - Jamb

Section Q-Q - Stable door meeting

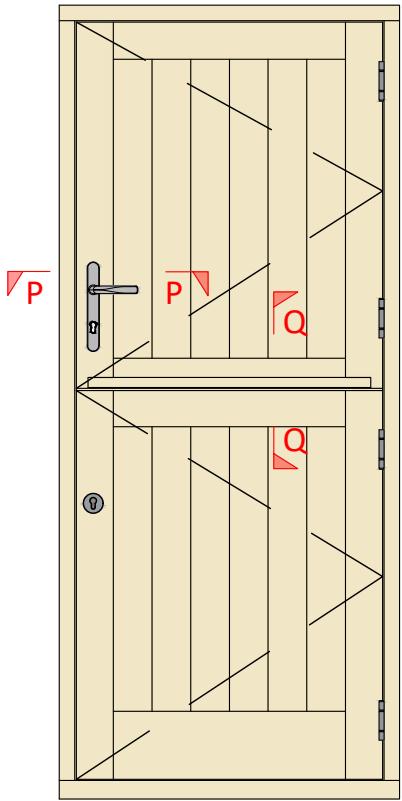
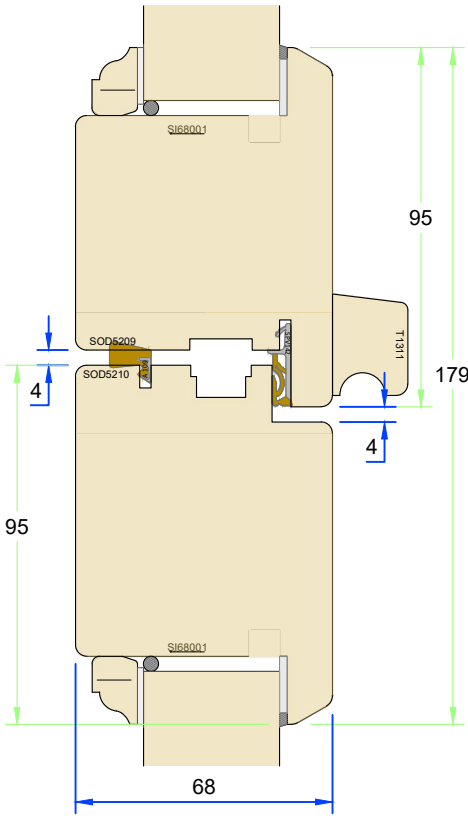
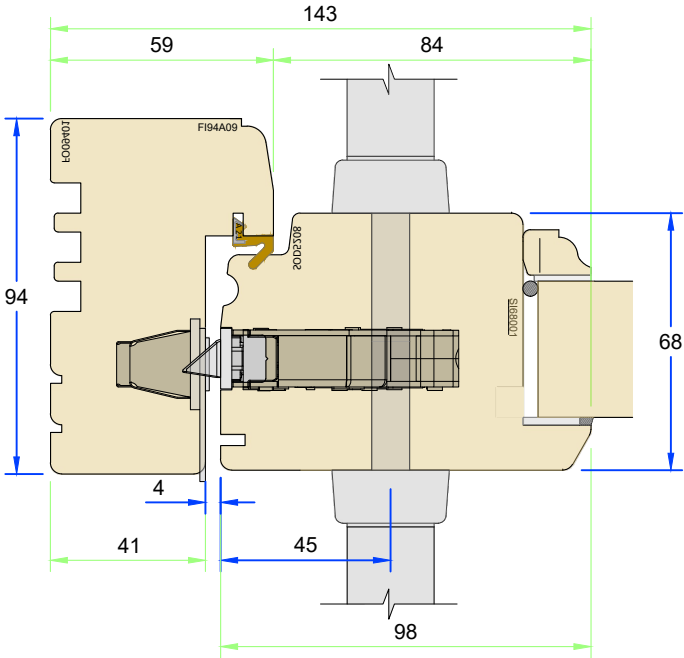

Variable Dimensions
(Dim shown is usually min)
Fixed Dimensions
Localised routing

| | | | |
|--|----------|------|----------------|
| Part No. T-DS5-94-68 | | | |
| Title: Traditional plus - Outward opening doorset (68mm) | | | |
| Scale: | As shown | Rev: | Date: 19.12.24 |
| Drawn By: | MKH | No.: | T-DS5-94-68-5 |

FRAME OPTIONS
(All details 1:2)

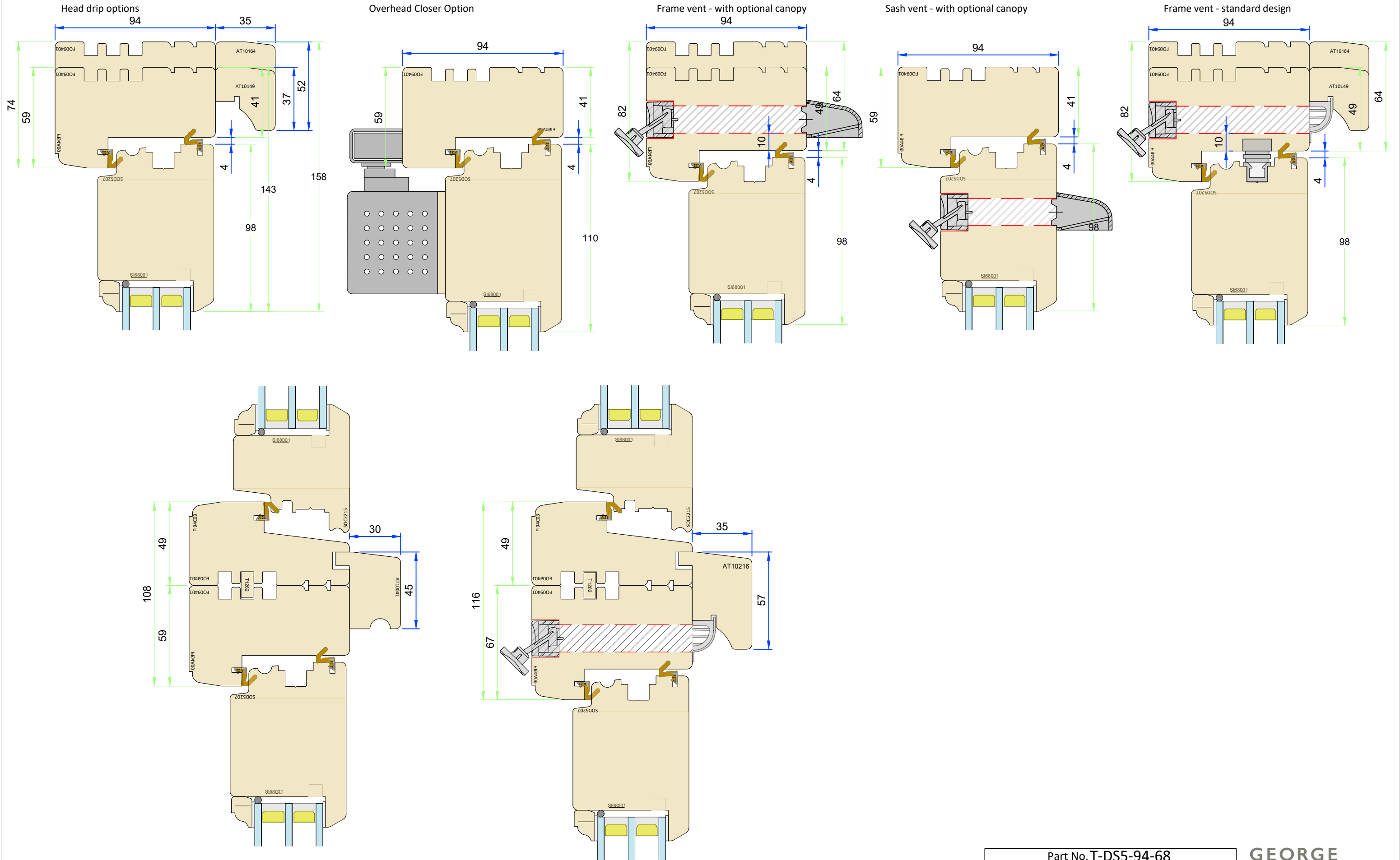

olerances are to George Barnsdale Standard Tolerance definitions (see supporting document for more detail) unless stated on the drawing.
ale & Sons Ltd. All rights reserved. No part of this drawing may be reproduced without the permission of George Barnsdale & Son Ltd.

Variable Dimensions
(Dim shown is usually min)

Fixed Dimensions

Localised routing

| | | | |
|--|----------|------|----------------|
| Part No. T-DS5-94-68 | | | |
| Title: Traditional plus - Outward opening doorset (68mm) | | | |
| Scale: | As shown | Rev: | Date: 19.12.24 |
| Drawn By: | MKH | No.: | T-DS5-94-68-6 |

**GEORGE
BARNSDALE**
Est. 1884
High Street, Donington, Spalding, Lincs, PE11 4TA
01775 823000
www.georgebarnsdale.co.uk

SECURITY CONTACTS
(All details 1:2)

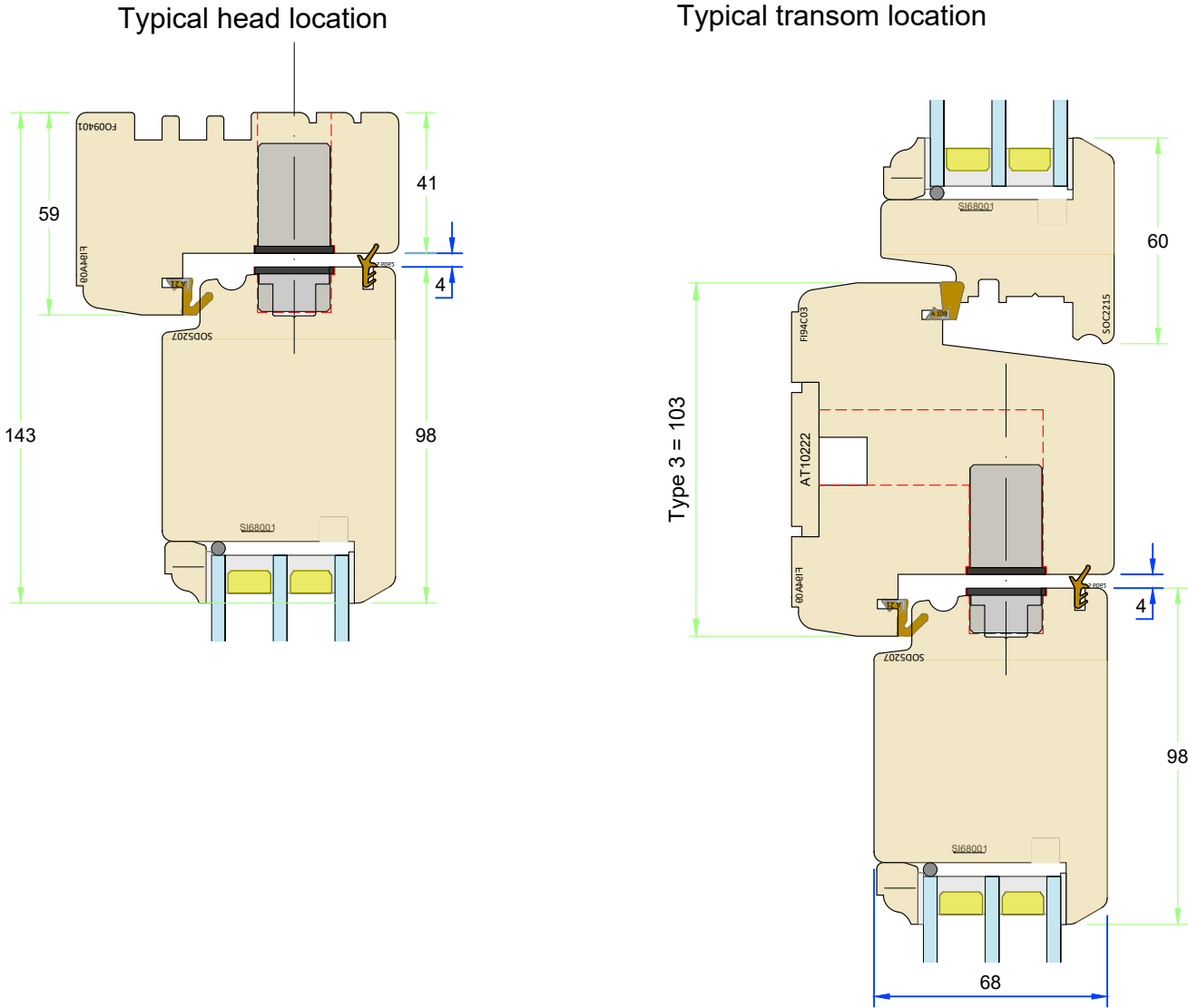

DOOR HINGE OPTIONS
(All details 1:2)

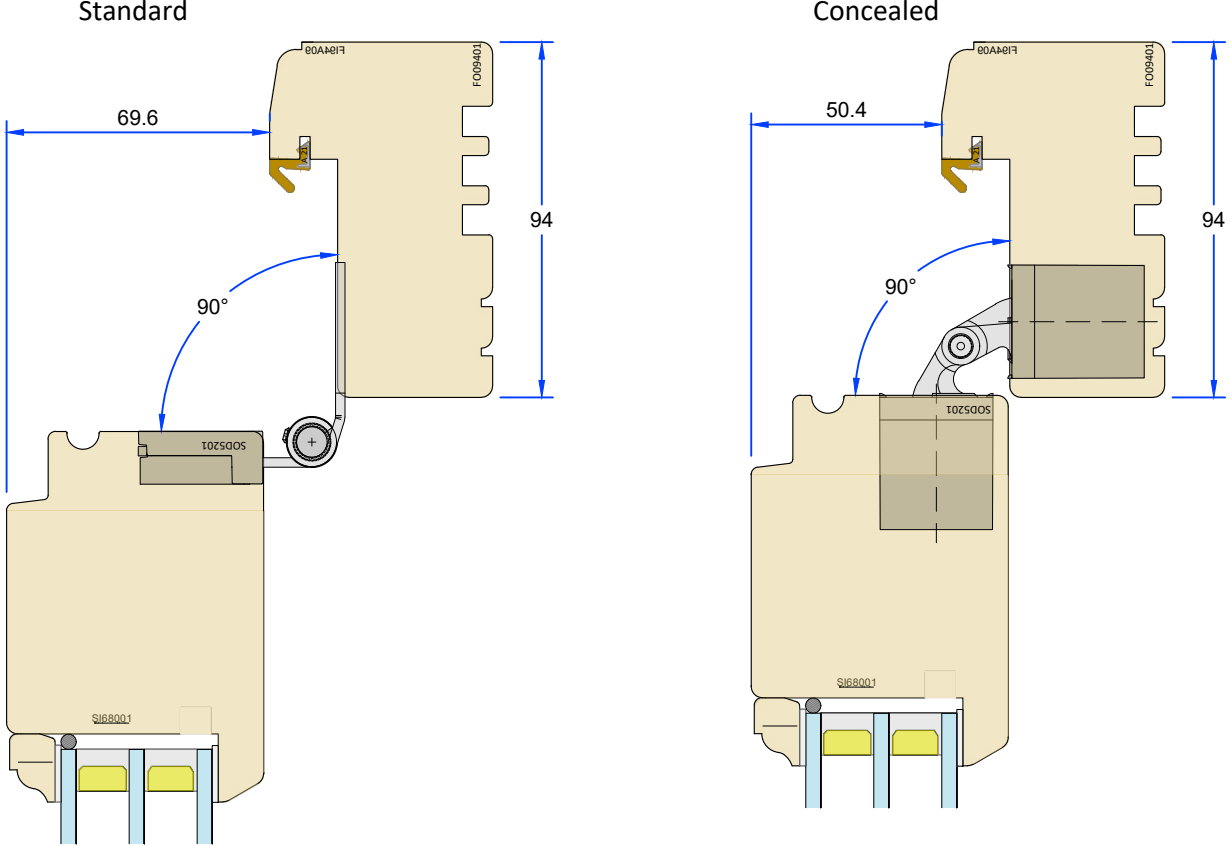

Stable door lock and frame

French Meeting
Timber Weather Bar

Timber Weather Bar Edge

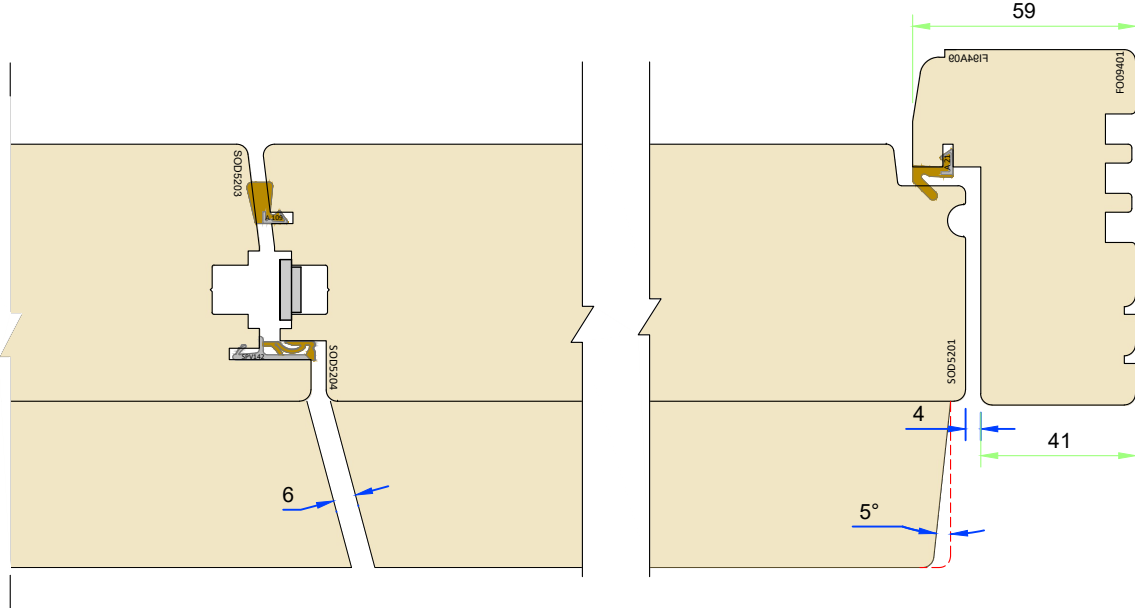

Flush quick fit door contact details

Magnet information

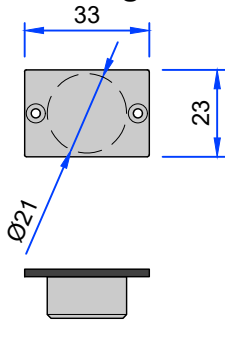

Contact information

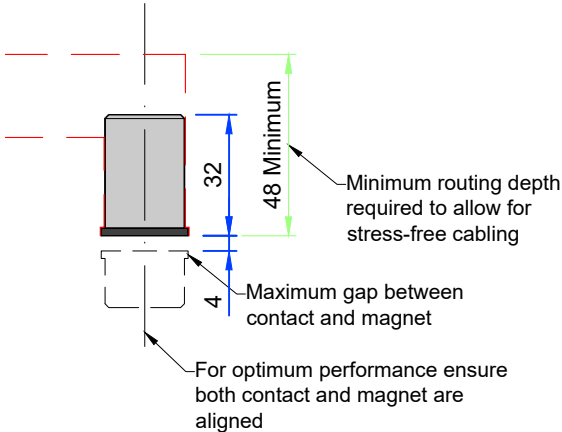

olerances are to George Barnsdale Standard Tolerance definitions (see supporting document for more detail) unless stated on the drawing.
ale & Sons Ltd. All rights reserved. No part of this drawing may be reproduced without the permission of George Barnsdale & Son Ltd.

Variable Dimensions
(Dim shown is usually min)

Fixed Dimensions

Localised routing

| | | | |
|---|----------|------|----------------|
| Part No. T-DS5-94-68 | | | |
| Title: Traditional plus - Outward opening doorset (68mm) Internal use only | | | |
| Scale: | As shown | Rev: | Date: 19.12.24 |
| Drawn By: | MKH | No.: | T-DS5-94-68-7 |

GEORGE
BARNSDALE
Est. 1884
High Street, Donington, Spalding, Lincs, PE11 4TA
01775 823000
www.georgebarnsdale.co.uk