

**ELEVATIONS**

Elevation 1 - Outside View (Scale 1:10)

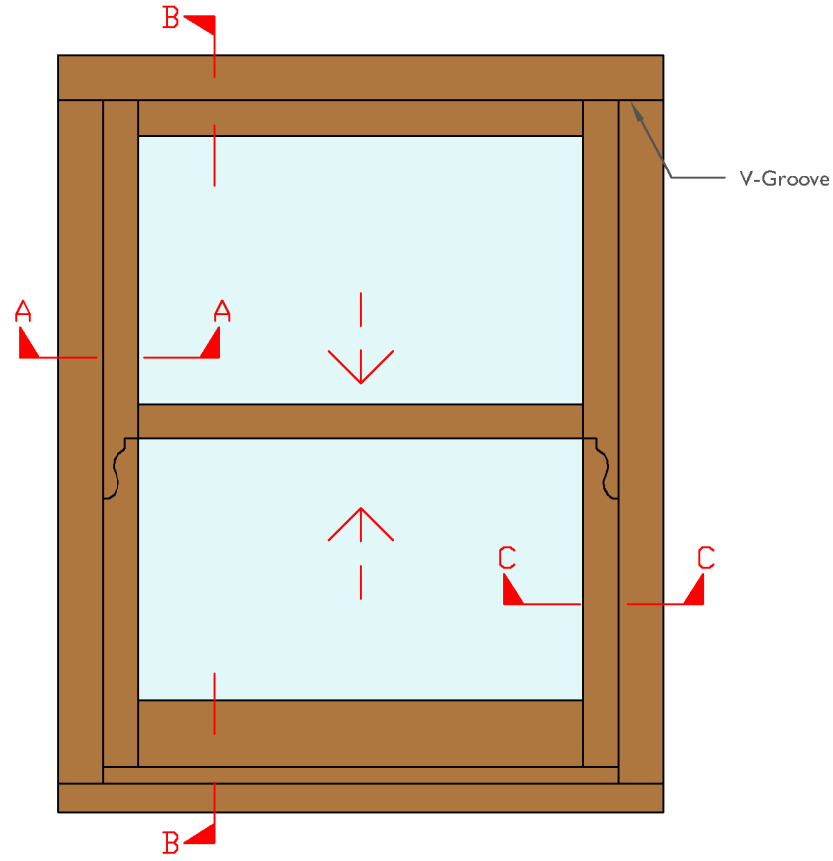

Elevation 2 - Inside View (Scale 1:10)

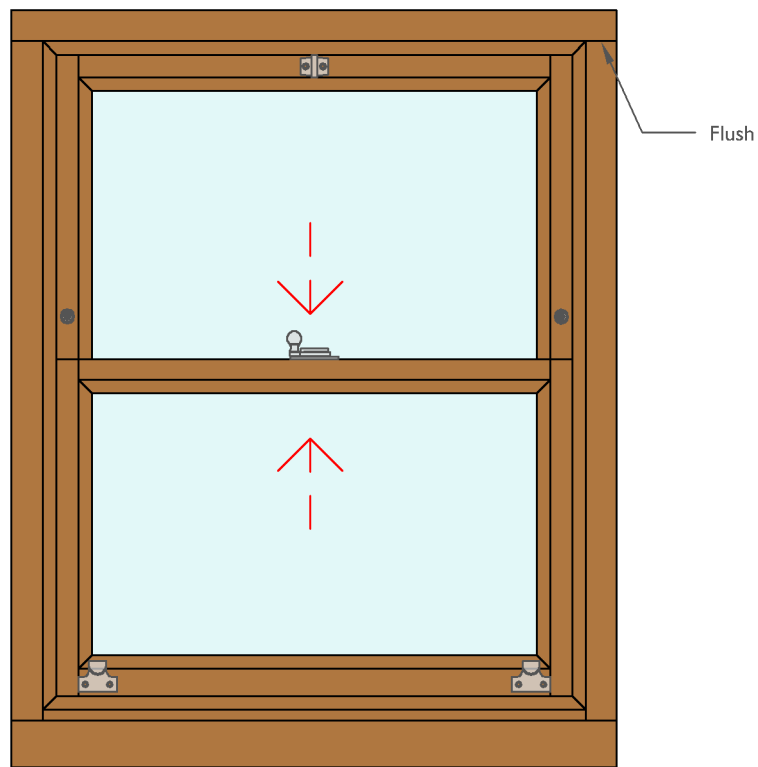

**SECTIONS**

Section A-A - Upper Jamb (Scale 1:2)

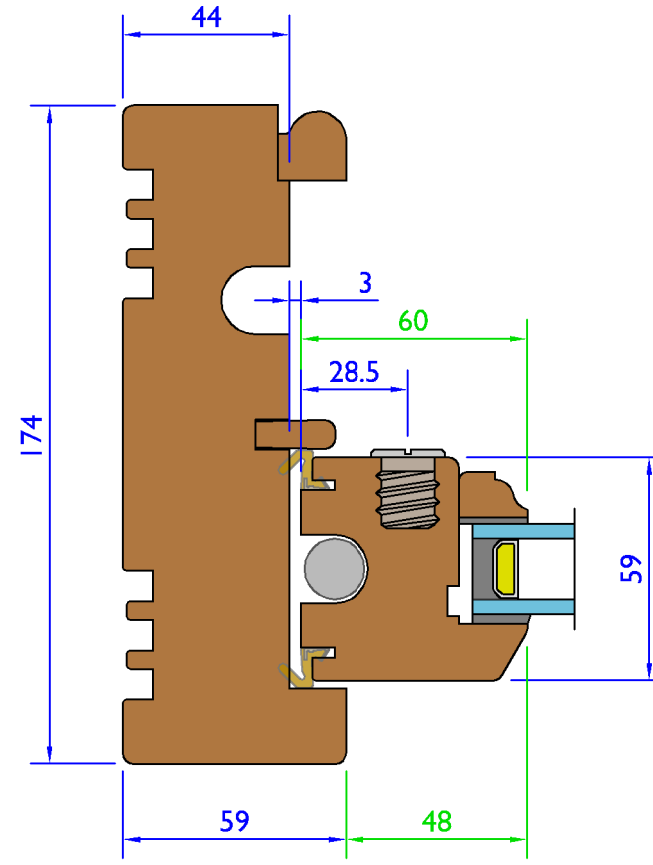

Section C-C - Lower Jamb (Scale 1:2)

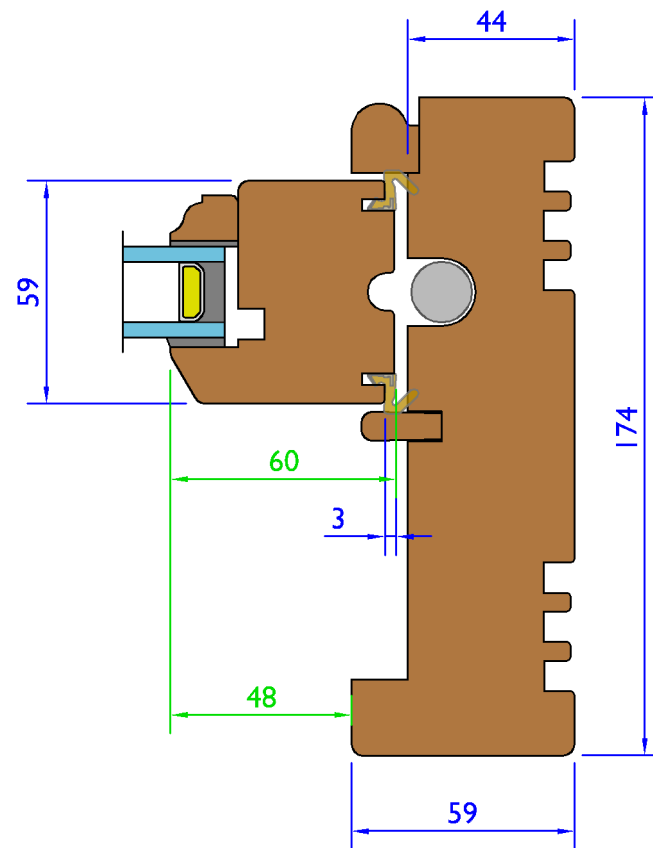

Section B-B - Head, Cill & Meeting Rails (Scale 1:2)

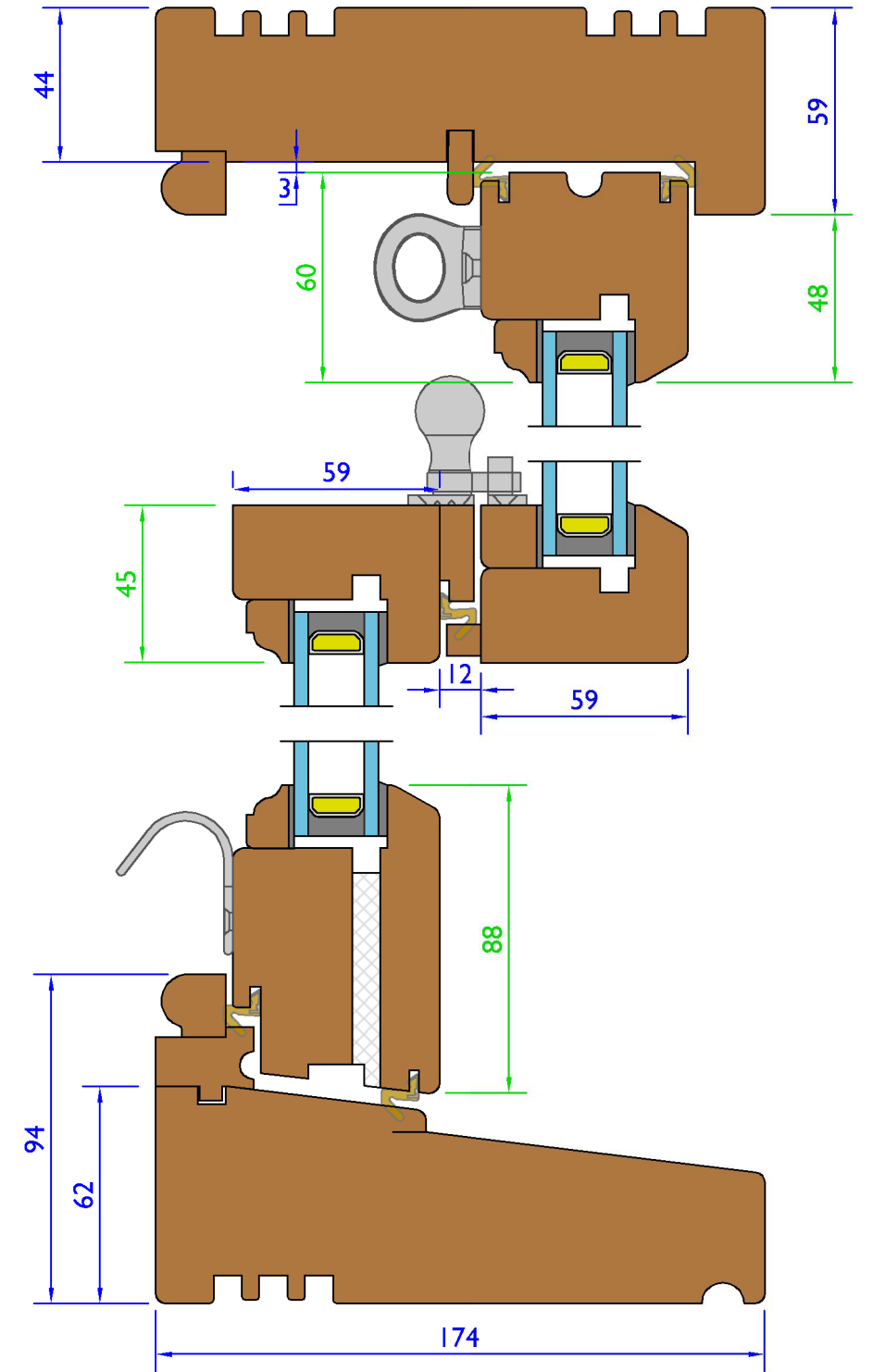

Drainage System

Variable Dimensions  
(Dim shown is usually min)

Fixed Dimensions

Tolerances: All tolerances are to George Barnsdale Standard Tolerance definitions (see supporting document for more detail) unless stated on the drawing.  
© George Barnsdale & Sons Ltd. All rights reserved. No part of this drawing may be reproduced without the permission of George Barnsdale & Son Ltd.

System: T-S2-174		
Title: Traditional - Spring Balance Sash Window (59mm)		
Scale:	As Shown	Rev No: B
Drawn By:	LH	Sheet No: 1
Date:	11-May-18	Status: Released

**GEORGE BARNSDALE**  
Est. 1884  
High Street, Donington, Spalding, Lincs, PE11 4TA  
01775 823000  
www.georgebarnsdale.co.uk

**SASH AND FRAME OPTIONS**

Cill Extension Option - 45mm - (Scale 1:2)

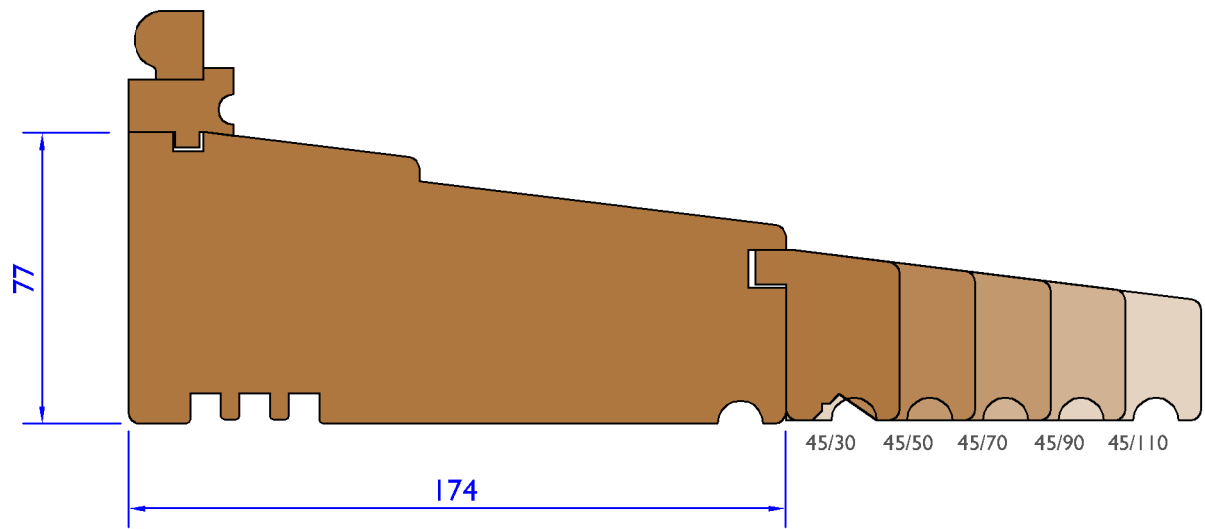

Cill Extension Option - 35mm - (Scale 1:2)

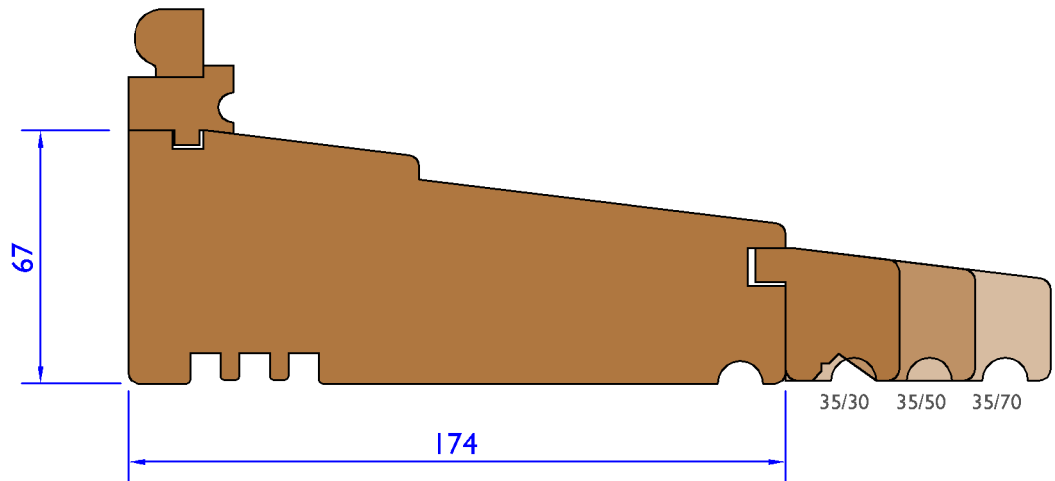

Cill Extension Option - 30mm - (Scale 1:2)

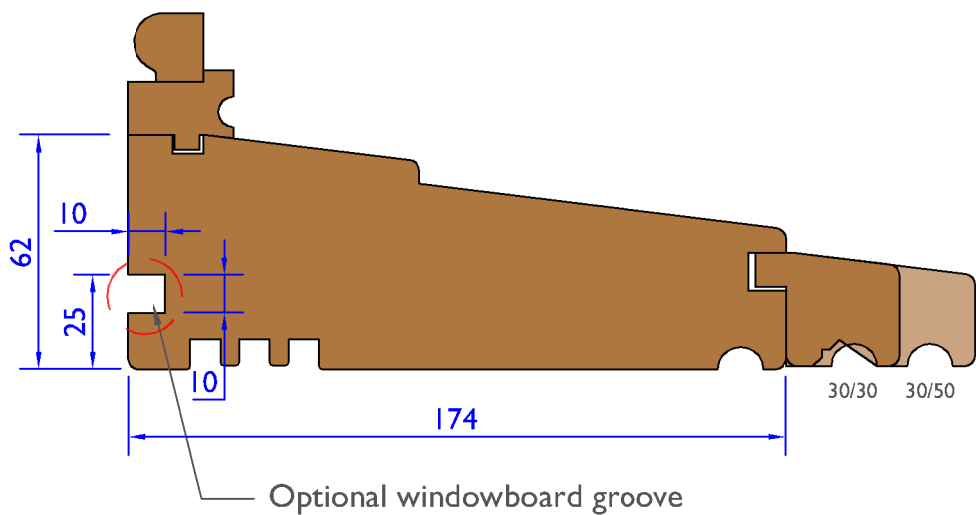

Transome Detail - Section D-D - (Scale 1:2)

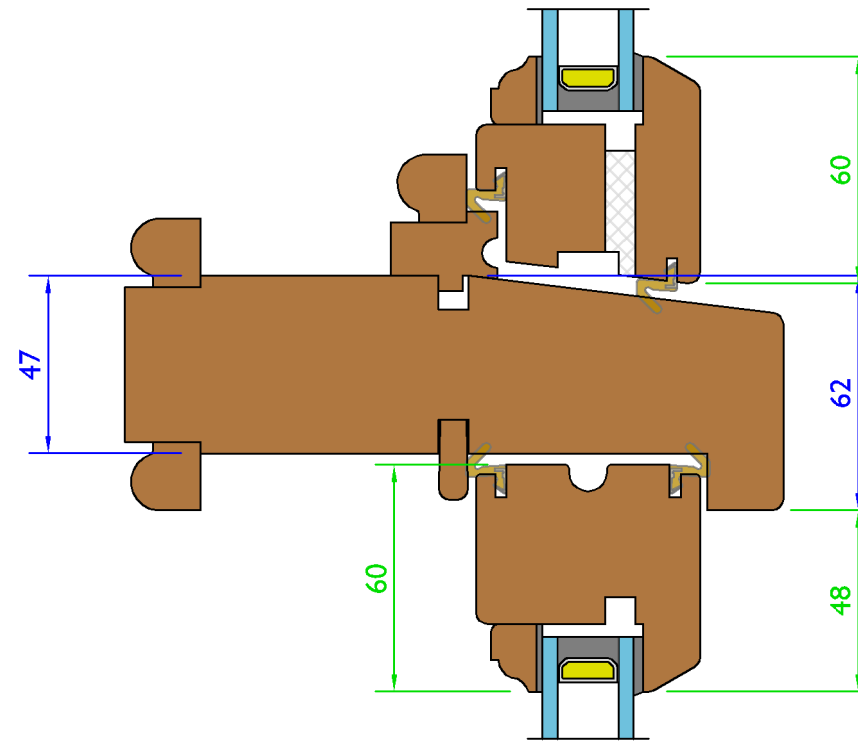

Mullion Detail - Section E-E - (Scale 1:2)

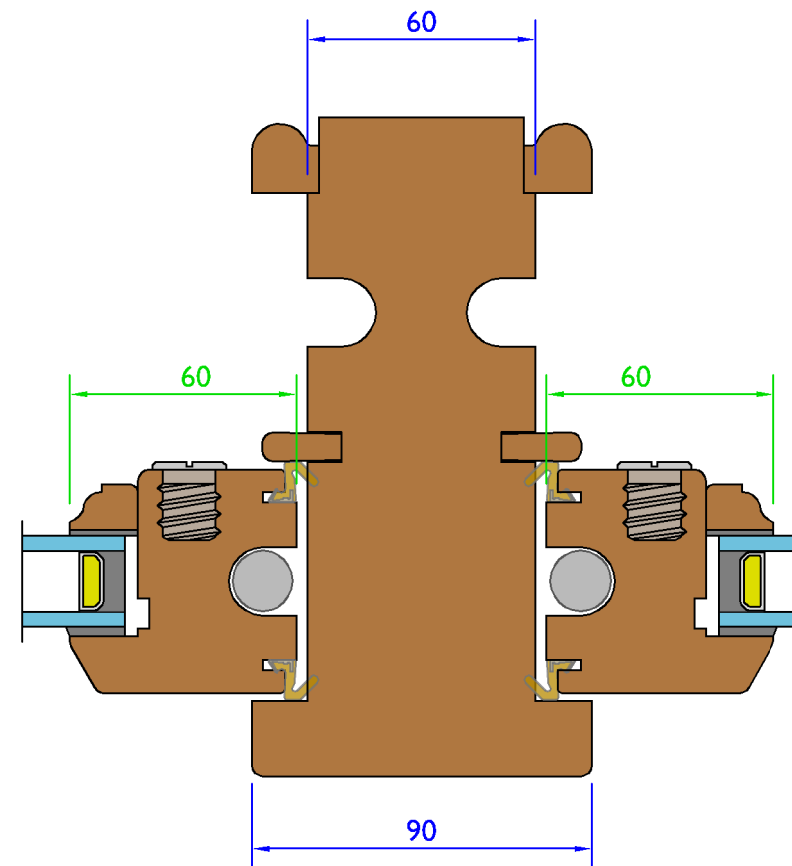

Arch Elevation - (Scale 1:20)

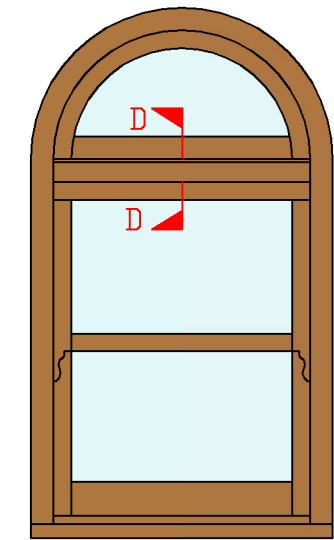

Double window Elevation - (Scale 1:20)

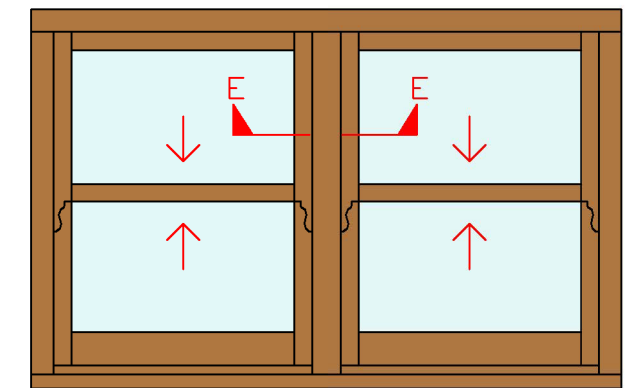

Drainage System

Variable Dimensions  
(Dim shown is usually min)

Fixed Dimensions

Tolerances: All tolerances are to George Barnsdale Standard Tolerance definitions (see supporting document for more detail) unless stated on the drawing.  
© George Barnsdale & Sons Ltd. All rights reserved. No part of this drawing may be reproduced without the permission of George Barnsdale & Son Ltd.

System: T-S2-174		
Title: Traditional - Spring Balance Sash Window (59mm)		
Scale:	As Shown	Rev No: B
Drawn By:	LH	Sheet No: 2
Date:	11-May-18	Status: Released

**GEORGE BARNSDALE**  
Est. 1884  
High Street, Donington, Spalding, Lincs, PE11 4TA  
01775 823000  
www.georgebarnsdale.co.uk

Frame Vent Elevation Showing Hidden Slot Size - (Scale 1:10)

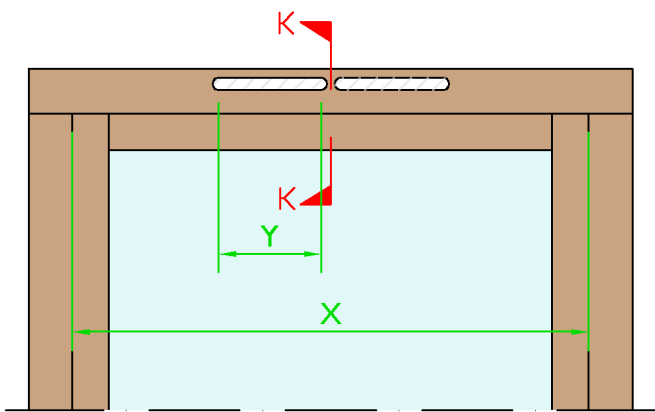

Vent not possible if X is under 400mm

Frame Vent Detail Section K-K - (Scale 1:2)

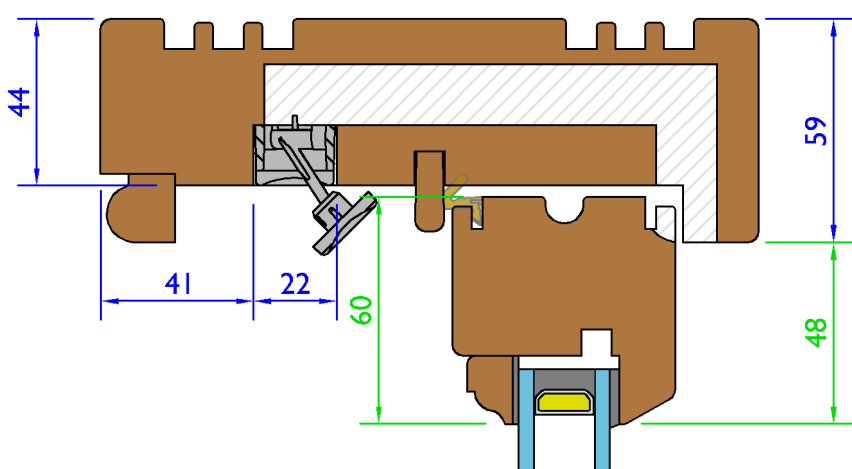

Extended Lining Option - (Scale 1:2)

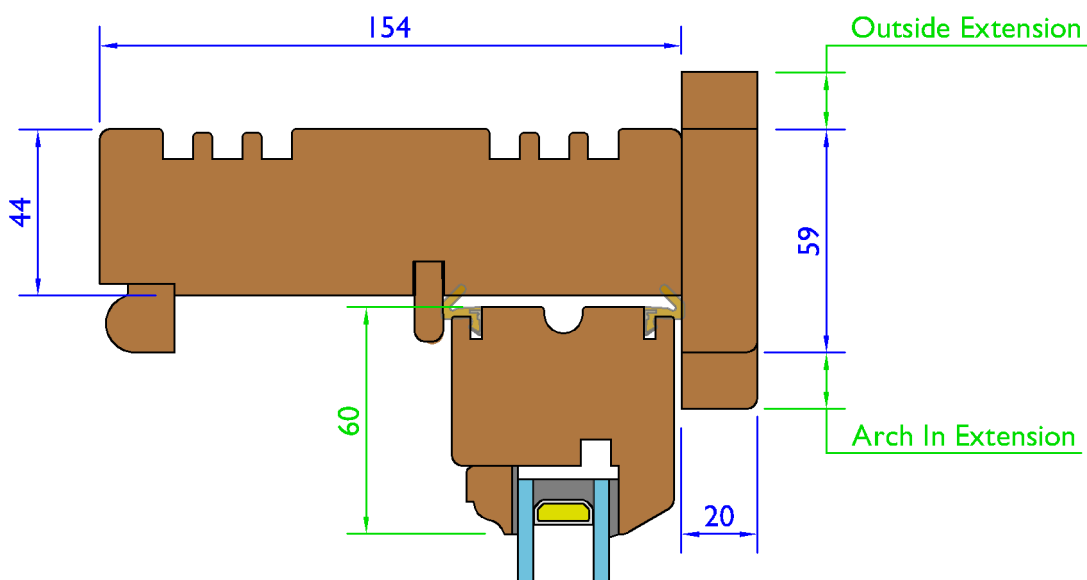

Shallow Arch Elevation Detail - (Scale 1:10)

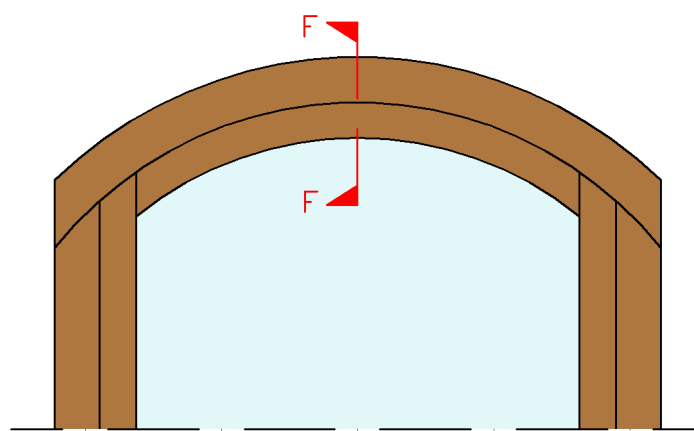

Semi-circular Arch Elevation Detail - (Scale 1:10)

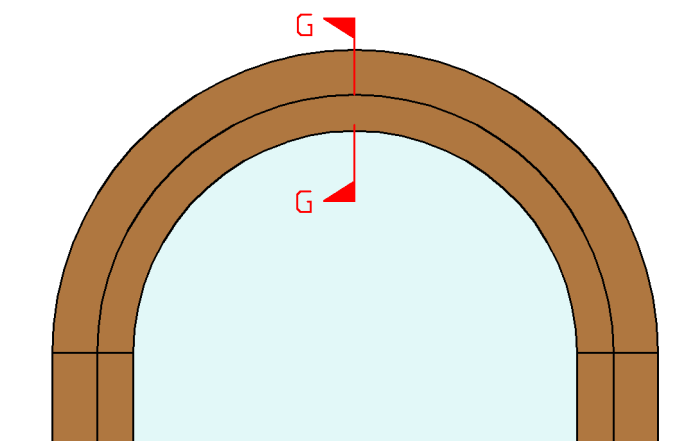

**ARCHED HEAD**

Arch Detail Section F-F and G-G - (Scale 1:2)

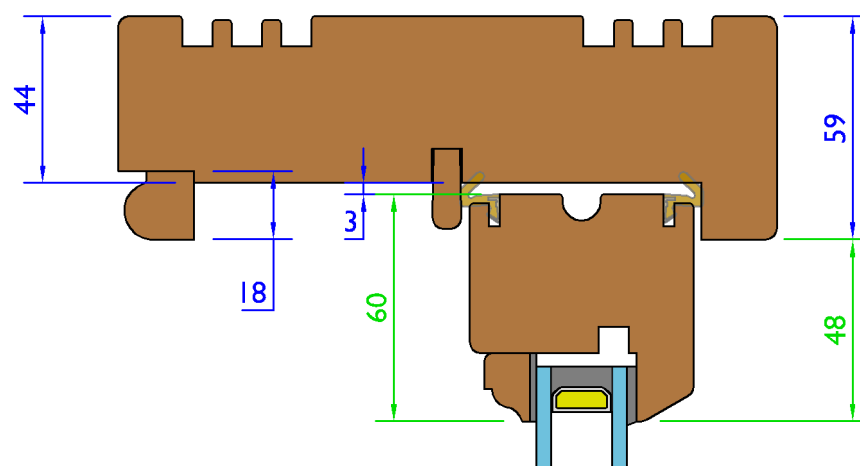

**MEETING RAIL PLUGS DETAILS**

Bottom sash meeting rail brush seal - (Scale 1:2)

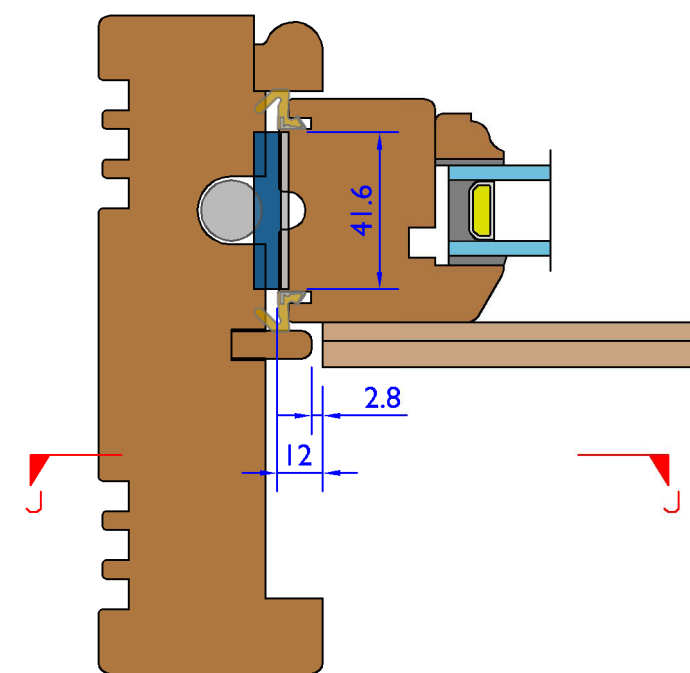

Elevation view of section J-J, parting bead seal (Scale 1:2)

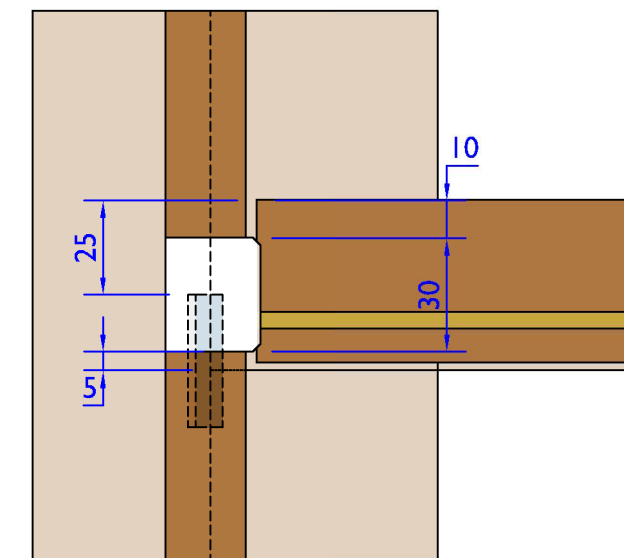

Vent System

Variable Dimensions  
(Dim shown is usually min)

Fixed Dimensions

Tolerances: All tolerances are to George Barnsdale Standard Tolerance definitions (see supporting document for more detail) unless stated on the drawing.  
© George Barnsdale & Sons Ltd. All rights reserved. No part of this drawing may be reproduced without the permission of George Barnsdale & Son Ltd.

System: T-S2-174		
Title: Traditional - Spring Balance Sash Window (59mm)		
Scale:	Rev No:	Date:
As Shown	B	11-May-18
Drawn By:	Sheet No:	Status:
LH	3	Released

**GEORGE BARNSDALE**  
Est. 1884  
High Street, Donington, Spalding, Lincs, PE11 4TA  
01775 823000  
www.georgebarnsdale.co.uk

**SASH HORN OPTIONS** (Scale 1:2)

Sash Horn Type A

Sash Horn Type B

Sash Horn Type C

Sash Horn Type D

Sash Horn Type E

Sash Horn Type F

Sash Horn Type G

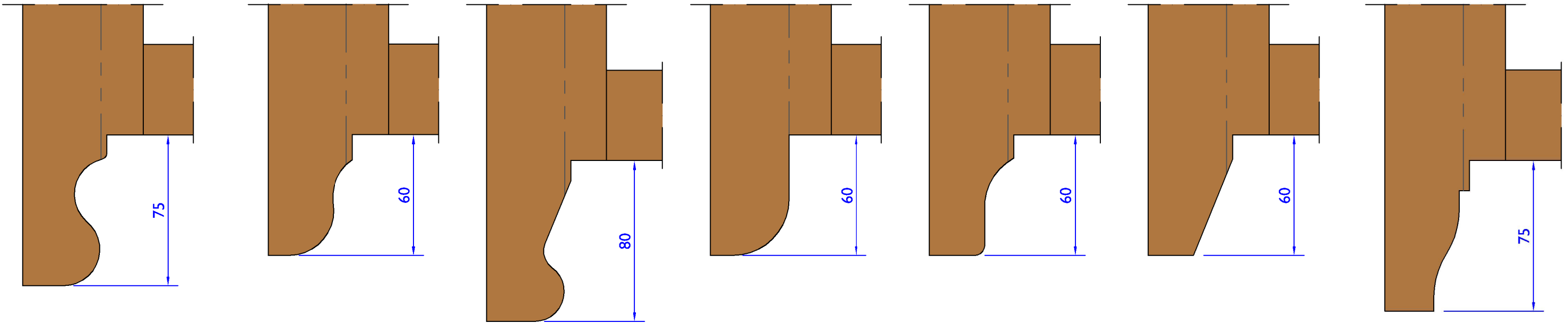

**Sash Pull Position**

(sash width <900 mm) - (Scale 1:10)

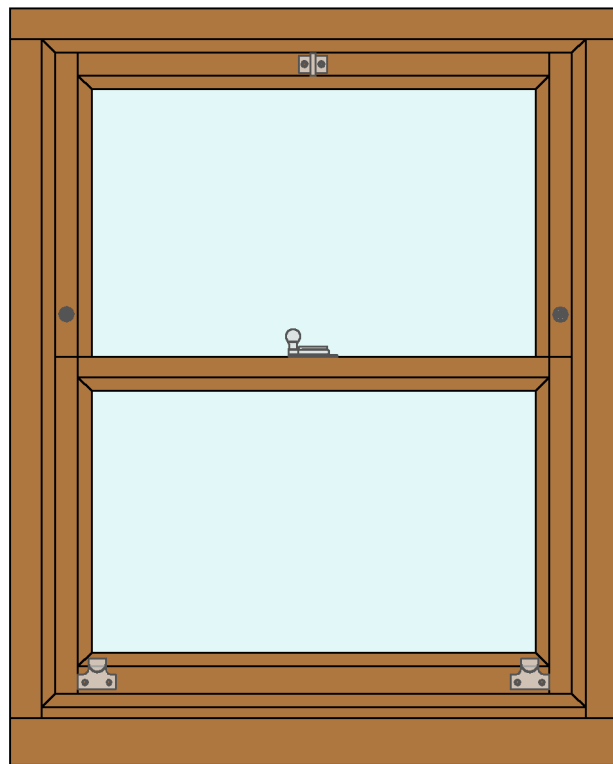

Sash pull aligned with sash rebate. Sash fastener centralised unless glazing bar requires it to be offset (offset to RHS when viewed from inside unless specified otherwise)

**Sash Pull + Fastener Position**

(sash width >900 mm) - (Scale 1:10)

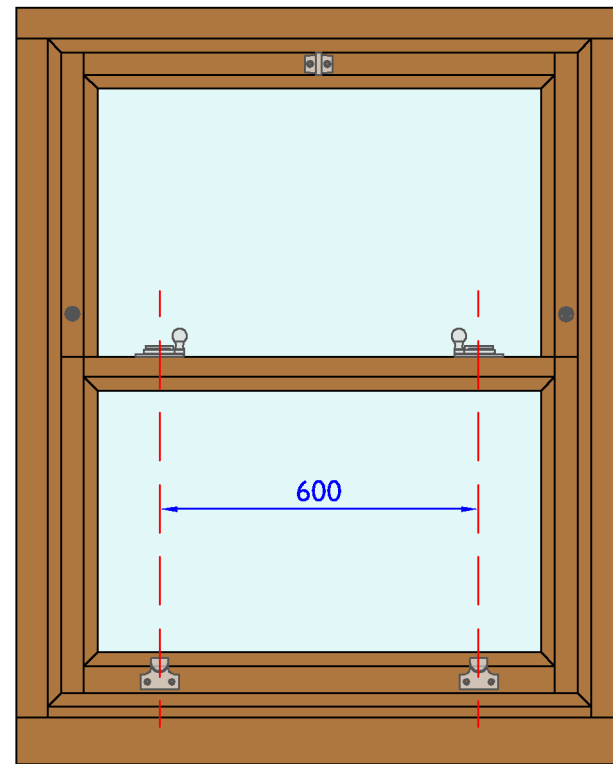

Sash pull aligned with sash fastener. Pull and fastener position as shown unless glazing bar requires alternative position which should then be positioned for best aesthetic by operator.

**Double Sash Stop Option - (Scale 1:5)**

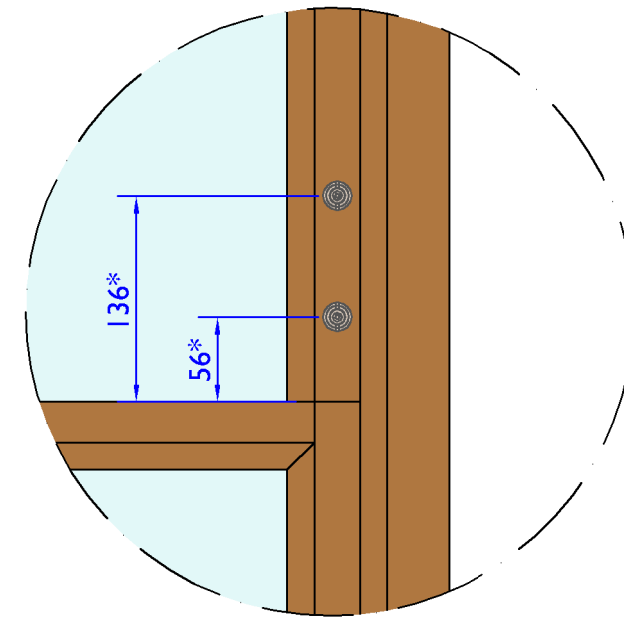

\* Dimensions shown provide (100mm and 20mm respectively), ventilation openings at the bottom of the window

— Variable Dimensions  
(Dim shown is usually min)

— Fixed Dimensions

System: T-S2-174		
Title: Traditional - Spring Balance Sash Window (59mm)		
Scale:	Rev No:	Date:
As Shown	B	11-May-18
Drawn By:	Sheet No:	Status:
LH	4	Released

Angular Bay Corner Post Option - (Scale 1:2)

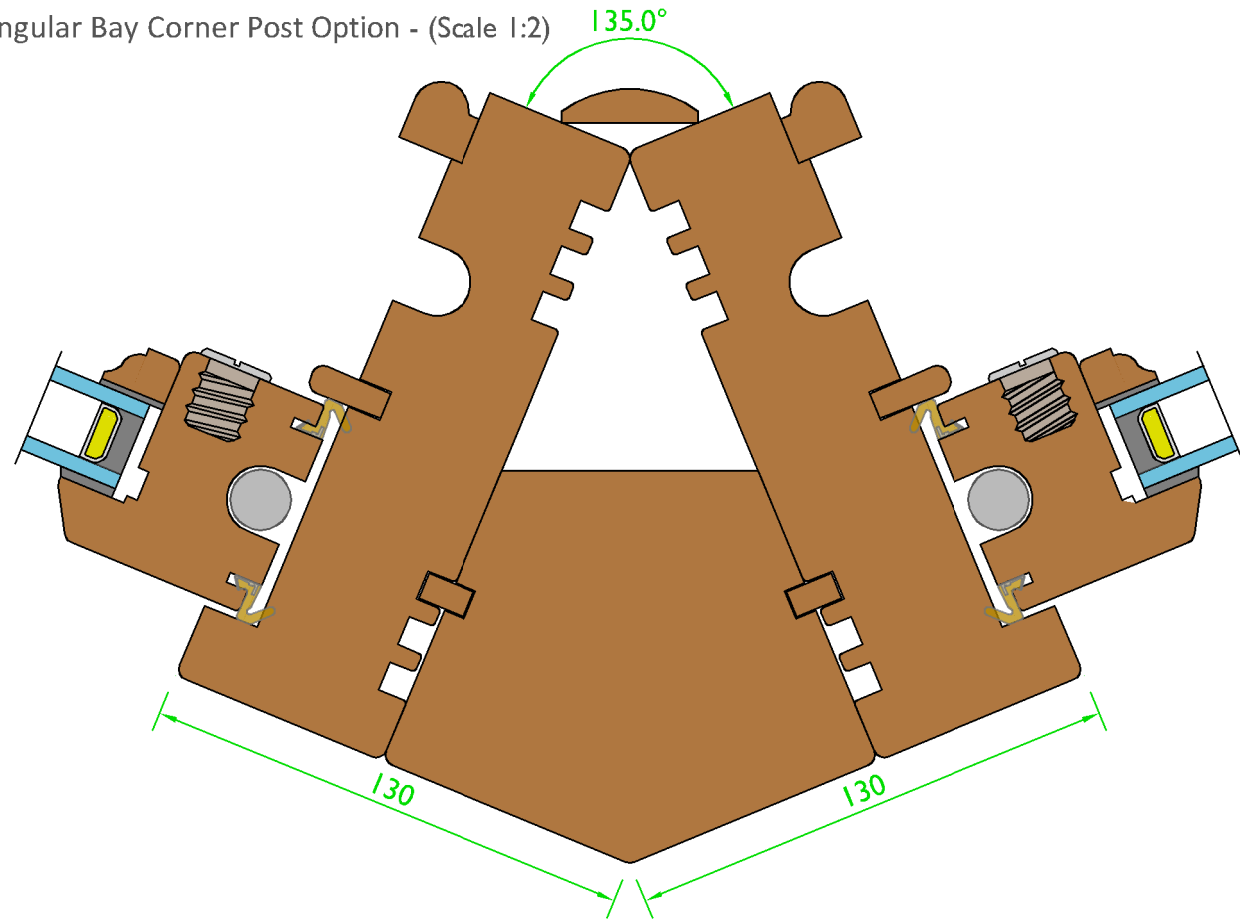

Square Bay Corner Post Option - (Scale 1:2)

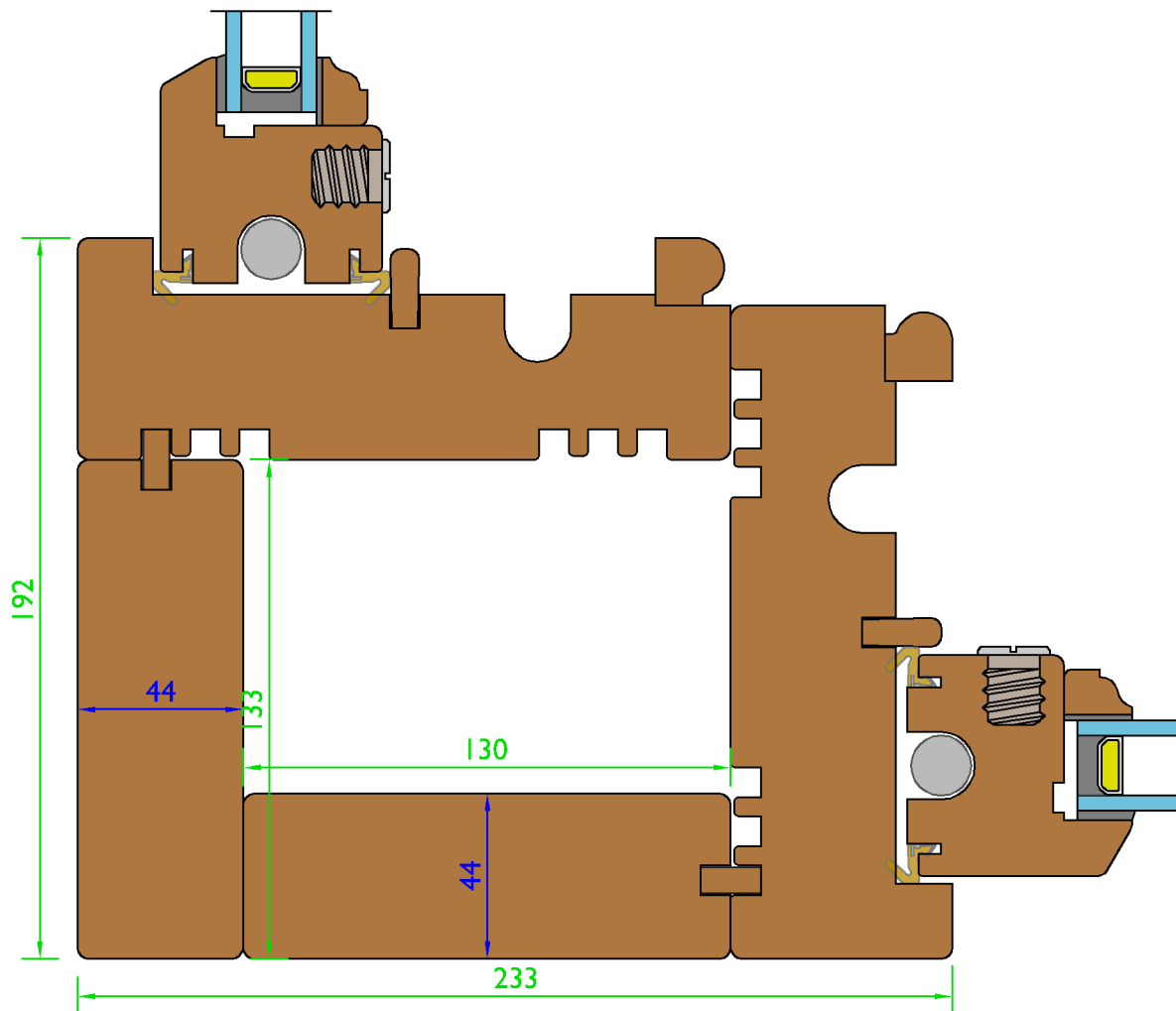

Frame Outside Profile Options - (Scale 1:2)

Ovolo Profile Option - (Scale 1:2)

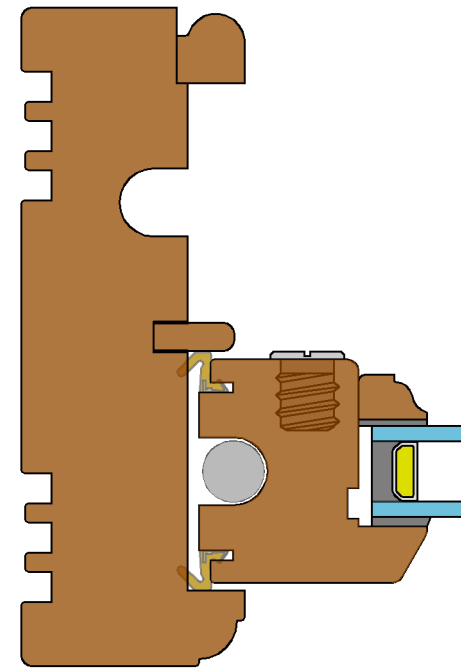

Bead Profile Option - (Scale 1:2)

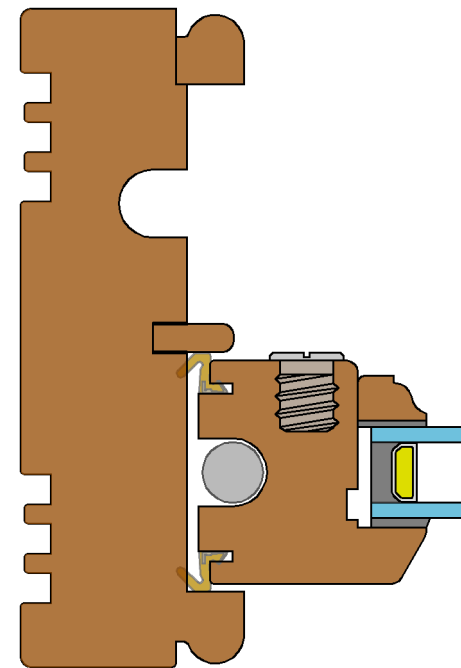

Frame Inside & Sash Outside Profile Options - (Scale 1:2)

Frame Inside Type F - (Scale 1:2)

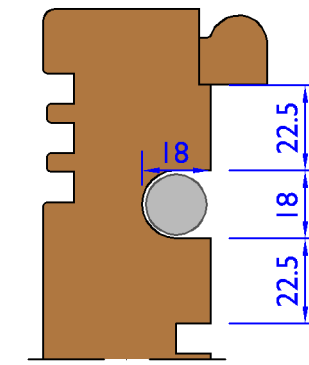

Frame Inside Type K - (Scale 1:2)

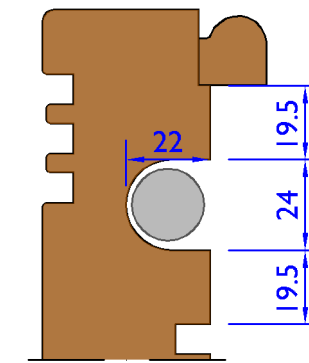

Side Rail Type F - (Scale 1:2)

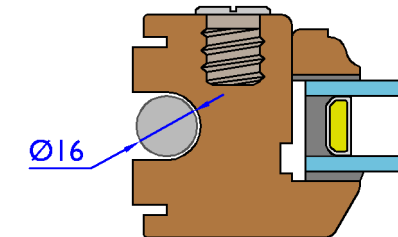

Side Rail Type K - (Scale 1:2)

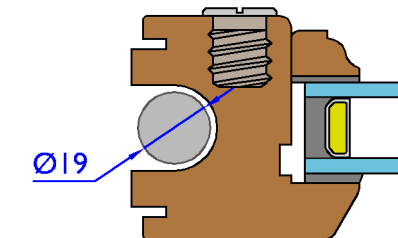

Variable Dimensions  
(Dim shown is usually min)

Fixed Dimensions

System: T-S2-174		
Title: Traditional - Spring Balance Sash Window (59mm)		
Scale:	Rev No:	Date:
As Shown	B	11-May-18
Drawn By:	Sheet No:	Status:
LH	5	Released

**GEORGE BARNSDALE**  
Est. 1884  
High Street, Donington, Spalding, Lincs, PE11 4TA  
01775 823000  
www.georgebarnsdale.co.uk

Tolerances: All tolerances are to George Barnsdale Standard Tolerance definitions (see supporting document for more detail) unless stated on the drawing.  
© George Barnsdale & Sons Ltd. All rights reserved. No part of this drawing may be reproduced without the permission of George Barnsdale & Son Ltd.